

Summer 2017 Promotion



SUMITOMO

CARBIDE - CBN - DIAMOND

Promo valid through July 31, 2017

Let Sumitomo help you meet your productivity goals!

GND Grooving Toolholders



GND Promo Details

2 Ways to Save

1. GND Kit Pricing:

Includes Holder and 5 Inserts

Polygon Shank GND Kit Pricing:

Includes Holder, Cassette & 5 Inserts

2. Buy Inserts, Get Holder FREE!

Milling Cutters: TSX, WEX, WFX, DFC, WGX, DGC, MSX & RSX

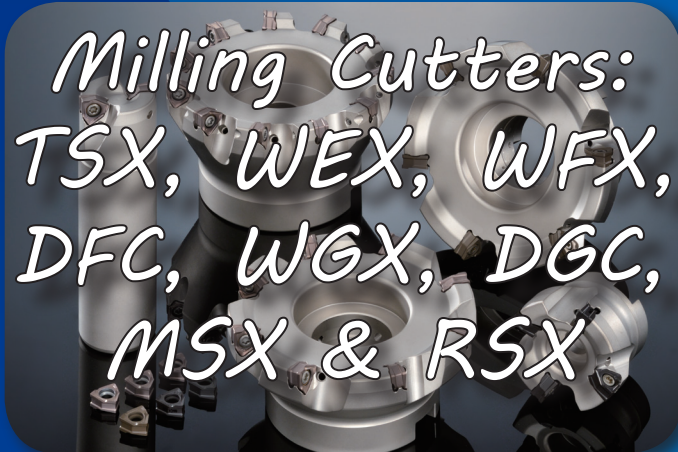

Milling Promo Details

3 Ways to Save

1. Buy Inserts, Get Cutter FREE

2. Kit Price: Includes cutter & 10 inserts

**3. Special Promo Price
on Shell Mill Holders**

(see page 18 for details)

WDX Indexable Drills



WDX Promo Details

1. Kit Price: Includes Drill & 10 Inserts

More Details @
[sumicarbide.com!](http://sumicarbide.com)



GNDM - External Multi-Purpose (Grooving / Turning / Profiling)

Fig. 1

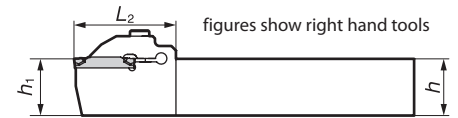
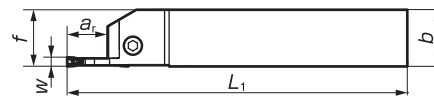

GNDMS - External 90° (Side Cut) Multi-Purpose (Grooving / Turning / Profiling)

Fig. 2

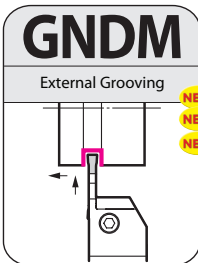
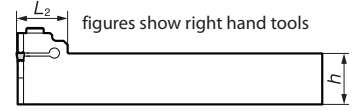
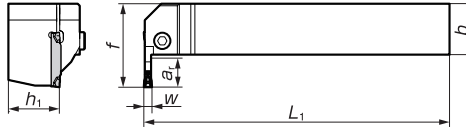

Use for multi-purpose or profiling insert for turning (widening).

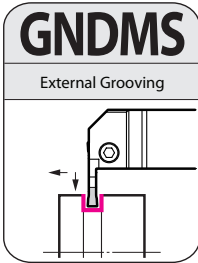

Use for multi-purpose or profiling insert for turning (widening).

GNDM Catalog Number	Dimensions (in)							Groove Width W (inch)	Max. Groove Depth a _r (inch)	Insert Seat Size	Fig.	Cap Screw	Wrench	Kit Price	Buy Inserts Get Holder FREE
	h	b	L ₁	f	h ₁	L ₂									
NEW GNDM R/L101.5JX-038	.625	.625	4.75	.625	-	1.102	.0625	.375	1.5	1	BX0515	LH040	\$150.67	20	
NEW GNDM R/L102JX-047	.625	.625	4.75	.625	-	1.181	.094	.472	2	1			\$150.67		
NEW GNDM R/L103JX-047	.625	.625	4.75	.625	-	1.181	.125	.472	3	1			\$153.33		
GNDM L/R 122K-050	.750	.750	5.000	.750	.750	1.441	.094	.500	2	1	BX0520	LH040	\$150.67		
GNDM L/R 123K-050	.750	.750	5.000	.750	.750	1.441	.125	.500	3	1			\$153.33		
GNDM L/R 124K-070	.750	.750	5.000	.750	.750	1.772	.157	.700	4	1			\$156.00		
GNDM L/R 125K-070	.750	.750	5.000	.750	.750	1.772	.1875	.700	5	1			\$158.67		
GNDM L/R 126K-070	.750	.750	5.000	.750	.750	1.772	.250	.700	6	1			\$161.33		
GNDM L/R 162K-050	1.000	1.000	6.000	1.000	1.000	1.441	.094	.500	2	1			\$161.33		
GNDM L/R 163M-050	1.000	1.000	6.000	1.000	1.000	1.441	.125	.500	3	1			\$164.00		
GNDM L/R 164M-070	1.000	1.000	6.000	1.000	1.000	1.772	.157	.700	4	1			\$166.67		
GNDM L/R 165M-070	1.000	1.000	6.000	1.000	1.000	1.772	.1875	.700	5	1			\$169.33		
GNDM L/R 166M-070	1.000	1.000	6.000	1.000	1.000	1.772	.250	.700	6	1			\$172.00		
GNDM L/R 203P-050	1.250	1.250	6.750	1.250	1.250	1.441	.125	.500	3	1	BX0620	LH050	\$216.00		
GNDM L/R 204P-070	1.250	1.250	6.750	1.250	1.250	1.772	.157	.700	4	1			\$218.67		
GNDM L/R 205P-070	1.250	1.250	6.750	1.250	1.250	1.772	.1875	.700	5	1			\$221.33		
GNDM L/R 206P-070	1.250	1.250	6.750	1.250	1.250	1.772	.250	.700	6	1			\$224.00		
GNDM L/R 207P-070	1.250	1.250	6.750	1.250	1.250	2.000	.275	.700	7	1			\$226.67		
GNDM L/R 208P-070	1.250	1.250	6.750	1.250	1.250	2.000	.315	.700	8	1			\$234.67		
GNDMS L/R 123K-040	.750	.750	5.000	1.222	.750	1.000	.125	.4000	3	2	BX0520	LH040	\$173.33		
GNDMS L/R 124K-050	.750	.750	5.000	1.300	.750	1.000	.157	.5000	4	2			\$176.00		
GNDMS L/R 125K-050	.750	.750	5.000	1.300	.750	1.000	.1875	.5000	5	2			\$178.67		
GNDMS L/R 163M-050	1.000	1.000	6.000	1.551	1.000	1.000	.125	.5000	3	2			\$176.00		
GNDMS L/R 164M-055	1.000	1.000	6.000	1.630	1.000	1.000	.157	.5500	4	2			\$178.67		
GNDMS L/R 165M-055	1.000	1.000	6.000	1.630	1.000	1.000	.1875	.5500	5	2			\$181.33		
GNDMS L/R 166M-055	1.000	1.000	6.000	1.630	1.000	1.000	.250	.5500	6	2			\$184.00		

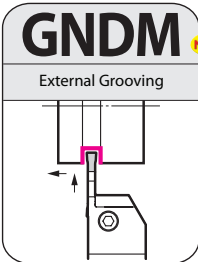

Use for multi-purpose or profiling insert for turning (widening).

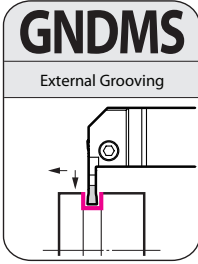

Use for multi-purpose or profiling insert for turning (widening).

GNDM Catalog Number	Dimensions (mm)							Groove Width w (mm)	Max. Groove Depth a _r (mm)	Insert Seat Size	Fig.	Cap Screw	Wrench	Kit Price	Buy Inserts Get Holder FREE
	h	b	L ₁	f	h ₁	L ₂									
NEW GNDM R/L1616JX-1.2508	16	16	120	16	16	26.0	1.25	8	1.25	1	BX0515	LH040	\$150.67	20	
GNDM R/L1616JX-1.510	16	16	120	16	16	26.0	1.5	10	1.5	1			\$150.67		
GNDM R/L1616JX-212	16	16	120	16	16	30.0	2.0	12	2	1			\$150.67		
GNDM R/L1616JX-312	16	16	120	16	16	30.0	3.0	12	3	1	\$153.33				
GNDM R/L2020K-312	20	20	125	20	20	36.6	3.0	12	3	1	BX0520	LH040	\$153.33		
GNDM R/L2020K-418	20	20	125	20	20	45.0	4.0	18	4	1			\$156.00		
GNDM R/L2020K-518	20	20	125	20	20	45.0	5.0	18	5	1			\$158.67		
GNDM R/L2020K-618	20	20	125	20	20	45.0	6.0	18	6	1			\$161.33		
GNDM R/L2525M-312	25	25	150	25	25	36.6	3.0	12	3	1			\$164.00		
GNDM R/L2525M-418	25	25	150	25	25	45.0	4.0	18	4	1			\$166.67		
GNDM R/L2525M-518	25	25	150	25	25	45.0	5.0	18	5	1			\$169.33		
GNDM R/L2525M-618	25	25	150	25	25	45.0	6.0	18	6	1			\$172.00		
GNDM R/L3232P-312	32	32	170	32	32	36.6	3.0	12	3	1			BX0620	LH050	\$216.00
GNDM R/L3232P-418	32	32	170	32	32	45	4.0	18	4	1					\$218.67
GNDM R/L3232P-518	32	32	170	32	32	45	5.0	18	5	1	\$221.33				
GNDM R/L3232P-618	32	32	170	32	32	45	6.0	18	6	1	\$224.00				
GNDM R/L3232P-718	32	32	170	32	32	50	7.0	18	7	1	\$226.67				
GNDM R/L3232P-818	32	32	170	32	32	50	8.0	18	8	1	\$234.67				
GNDMS R/L 2020K-310	20	20	125	32	20	25	3.0	10	3	2	BX0520	LH040	\$153.33		
GNDMS R/L 2020K-412	20	20	125	34	20	25	4.0	12	4	2			\$156.00		
GNDMS R/L 2020K-512	20	20	125	34	20	25	5.0	12	5	2			\$158.67		
GNDMS R/L 2525M-312	25	25	150	39	25	25	3.0	12	3	2			\$164.00		
GNDMS R/L 2525M-414	25	25	150	41	25	25	4.0	14	4	2			\$166.67		
GNDMS R/L 2525M-514	25	25	150	41	25	25	5.0	14	5	2			\$169.33		
GNDMS R/L 2525M-614	25	25	150	41	25	25	6.0	14	6	2	\$172.00				

See 17-18 General Catalog for hardware

Please see page 8 for applicable inserts

Face Grooving - INCH

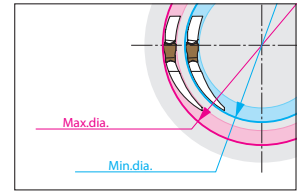
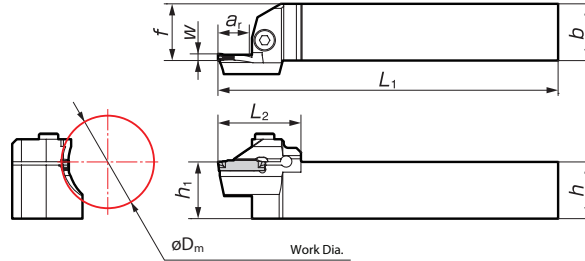
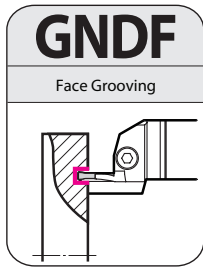

Work diameters in the table below indicate external diameter of face groove.

Above figures show right hand tools

INCH Catalog Number	Dimensions (in)						Work Dia. ØDm		Grooving width	Max. Grooving Depth ar (inch)	Insert Seat Size	Cap Screw	Wrench	Kit Price	Buy Inserts Get Holder FREE
	h	b	L ₁	f	h ₁	L ₂	Min.	Max.							
GNDF L/R 123K-050-035	.750	.750	5.000	.750	.750	1.402	1.378	1.772	.125	.500	3				
GNDF L/R 123K-050-040	.750	.750	5.000	.750	.750	1.402	1.575	2.165	.125	.500	3				
GNDF L/R 123K-070-050	.750	.750	5.000	.750	.750	1.638	1.969	2.756	.125	.700	3				
GNDF L/R 123K-070-065	.750	.750	5.000	.750	.750	1.638	2.559	3.397	.125	.700	3	BX0520	LH040	\$153.33	20
GNDF L/R 123K-070-090	.750	.750	5.000	.750	.750	1.638	3.543	5.906	.125	.700	3				
GNDF L/R 123K-070-140	.750	.750	5.000	.750	.750	1.638	5.512	7.874	.125	.700	3				
GNDF L/R 123K-070-180	.750	.750	5.000	.750	.750	1.638	7.087	11.811	.125	.700	3				
GNDF L/R 124K-070-040	.750	.750	5.000	.750	.750	1.638	1.575	2.165	.157	.700	4				
GNDF L/R 124K-090-050	.750	.750	5.000	.750	.750	1.835	1.969	2.756	.157	.900	4				
GNDF L/R 124K-090-065	.750	.750	5.000	.750	.750	1.835	2.559	3.543	.157	.900	4				
GNDF L/R 124K-090-085	.750	.750	5.000	.750	.750	1.835	3.346	5.118	.157	.900	4	BX0520	LH040	\$156.00	20
GNDF L/R 124K-090-125	.750	.750	5.000	.750	.750	1.835	4.921	7.874	.157	.900	4				
GNDF L/R 124K-090-180	.750	.750	5.000	.750	.750	1.835	7.087	11.811	.157	.900	4				
GNDF L/R 124K-090-280	.750	.750	5.000	.750	.750	1.835	11.024	39.370	.157	.900	4				
GNDF L/R 125K-090-050	.750	.750	5.000	.750	.750	1.835	1.969	2.756	.1875	.900	5				
GNDF L/R 125K-090-065	.750	.750	5.000	.750	.750	1.835	2.559	3.543	.1875	.900	5				
GNDF L/R 125K-090-085	.750	.750	5.000	.750	.750	1.835	3.346	5.118	.1875	.900	5	BX0520	LH040	\$158.67	20
GNDF L/R 125K-090-125	.750	.750	5.000	.750	.750	1.835	4.921	7.874	.1875	.900	5				
GNDF L/R 125K-090-180	.750	.750	5.000	.750	.750	1.835	7.087	11.811	.1875	.900	5				
GNDF L/R 125K-090-280	.750	.750	5.000	.750	.750	1.835	11.024	39.370	.1875	.900	5				
GNDF L/R 126K-090-050	.750	.750	5.000	.750	.750	1.835	1.969	2.953	.250	.900	6				
GNDF L/R 126K-090-070	.750	.750	5.000	.750	.750	1.835	2.756	4.331	.250	.900	6				
GNDF L/R 126K-090-100	.750	.750	5.000	.750	.750	1.835	3.397	7.874	.250	.900	6	BX0520	LH040	\$161.33	20
GNDF L/R 126K-090-180	.750	.750	5.000	.750	.750	1.835	7.087	11.811	.250	.900	6				
GNDF L/R 126K-090-280	.750	.750	5.000	.750	.750	1.835	11.024	39.370	.250	.900	6				
GNDF L/R 163M-050-035	1.000	1.000	6.000	1.000	1.000	1.402	1.378	1.772	.125	.500	3				
GNDF L/R 163M-050-040	1.000	1.000	6.000	1.000	1.000	1.402	1.575	2.165	.125	.500	3				
GNDF L/R 163M-070-050	1.000	1.000	6.000	1.000	1.000	1.638	1.969	2.756	.125	.700	3				
GNDF L/R 163M-070-065	1.000	1.000	6.000	1.000	1.000	1.638	2.559	3.397	.125	.700	3	BX0520	LH040	\$164.00	20
GNDF L/R 163M-070-090	1.000	1.000	6.000	1.000	1.000	1.638	3.543	5.906	.125	.700	3				
GNDF L/R 163M-070-140	1.000	1.000	6.000	1.000	1.000	1.638	5.512	7.874	.125	.700	3				
GNDF L/R 163M-070-180	1.000	1.000	6.000	1.000	1.000	1.638	7.087	11.811	.125	.700	3				
GNDF L/R 164M-070-040	1.000	1.000	5.000	.750	.750	1.638	1.575	2.165	.157	.700	4				
GNDF L/R 164M-090-050	1.000	1.000	5.000	.750	.750	1.835	1.969	2.756	.157	.900	4				
GNDF L/R 164M-090-065	1.000	1.000	5.000	.750	.750	1.835	2.559	3.543	.157	.900	4				
GNDF L/R 164M-090-085	1.000	1.000	5.000	.750	.750	1.835	3.346	5.118	.157	.900	4	BX0520	LH040	\$166.67	20
GNDF L/R 164M-090-125	1.000	1.000	5.000	.750	.750	1.835	4.921	7.874	.157	.900	4				
GNDF L/R 164M-090-180	1.000	1.000	5.000	.750	.750	1.835	7.087	11.811	.157	.900	4				
GNDF L/R 164M-090-280	1.000	1.000	5.000	.750	.750	1.835	11.024	39.370	.157	.900	4				
GNDF L/R 165M-090-050	1.000	1.000	6.000	1.000	1.000	1.835	1.969	2.756	.1875	.900	5				
GNDF L/R 165M-090-065	1.000	1.000	6.000	1.000	1.000	1.835	2.559	3.543	.1875	.900	5				
GNDF L/R 165M-090-085	1.000	1.000	6.000	1.000	1.000	1.835	3.346	5.118	.1875	.900	5	BX0520	LH040	\$169.33	20
GNDF L/R 165M-090-125	1.000	1.000	6.000	1.000	1.000	1.835	4.921	7.874	.1875	.900	5				
GNDF L/R 165M-090-180	1.000	1.000	6.000	1.000	1.000	1.835	7.087	11.811	.1875	.900	5				
GNDF L/R 165M-090-280	1.000	1.000	6.000	1.000	1.000	1.835	11.024	39.370	.1875	.900	5				
GNDF L/R 166M-090-050	1.000	1.000	6.000	1.000	1.000	1.835	1.969	2.953	.250	.900	6				
GNDF L/R 166M-090-070	1.000	1.000	6.000	1.000	1.000	1.835	2.756	4.331	.250	.900	6				
GNDF L/R 166M-090-100	1.000	1.000	6.000	1.000	1.000	1.835	3.937	7.874	.250	.900	6	BX0520	LH040	\$172.00	20
GNDF L/R 166M-090-180	1.000	1.000	6.000	1.000	1.000	1.835	7.087	11.811	.250	.900	6				
GNDF L/R 166M-090-280	1.000	1.000	6.000	1.000	1.000	1.835	11.024	39.370	.250	.900	6				

Please see page 8 for applicable inserts

Face Grooving - METRIC

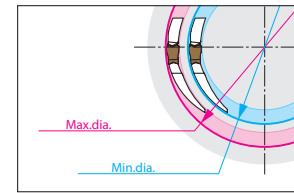
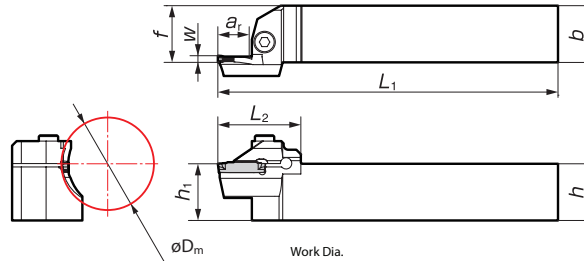
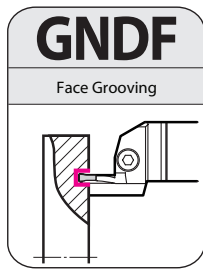

Work diameters in the table below indicate external diameter of face groove.

Above figures show right hand tools

METRIC Catalog Number	Dimensions (mm)						Work Dia. (mm)	Groove Width	Max. Groove Depth a _r (mm)	Insert Seat Size	Cap Screw	Wrench	Kit Price	Buy Inserts Get Holder FREE
	h	b	L ₁	f	h ₁	L ₂	ØD _m	w(mm)						
GNDF R/L2020K-312-035	20	20	125	20	20	35.6	35 to 45	3.0	12					
GNDF R/L2020K-312-040	20	20	125	20	20	35.6	40 to 55	3.0	12					
GNDF R/L2020K-318-050	20	20	125	20	20	41.6	50 to 70	3.0	18					
GNDF R/L2020K-318-065	20	20	125	20	20	41.6	65 to 100	3.0	18	3	BX0520	LH040	\$153.33	20
GNDF R/L2020K-318-090	20	20	125	20	20	41.6	90 to 150	3.0	18					
GNDF R/L2020K-318-140	20	20	125	20	20	41.6	140 to 200	3.0	18					
GNDF R/L2020K-318-180	20	20	125	20	20	41.6	180 to 300	3.0	18					
GNDF R/L2020K-418-040	20	20	125	20	20	41.6	40 to 55	4.0	18					
GNDF R/L2020K-423-050	20	20	125	20	20	46.6	50 to 70	4.0	23					
GNDF R/L2020K-423-065	20	20	125	20	20	46.6	65 to 90	4.0	23					
GNDF R/L2020K-423-085	20	20	125	20	20	46.6	85 to 130	4.0	23	4	BX0520	LH040	\$156.00	20
GNDF R/L2020K-423-125	20	20	125	20	20	46.6	125 to 200	4.0	23					
GNDF R/L2020K-423-180	20	20	125	20	20	46.6	180 to 300	4.0	23					
GNDF R/L2020K-423-280	20	20	125	20	20	46.6	280 to 1000	4.0	23					
GNDF R/L2020K-523-050	20	20	125	20	20	46.6	50 to 70	5.0	23					
GNDF R/L2020K-523-065	20	20	125	20	20	46.6	65 to 90	5.0	23					
GNDF R/L2020K-523-085	20	20	125	20	20	46.6	85 to 130	5.0	23	5	BX0520	LH040	\$158.67	20
GNDF R/L2020K-523-125	20	20	125	20	20	46.6	125 to 200	5.0	23					
GNDF R/L2020K-523-180	20	20	125	20	20	46.6	180 to 300	5.0	23					
GNDF R/L2020K-523-280	20	20	125	20	20	46.6	280 to 1000	5.0	23					
GNDF R/L2020K-623-050	20	20	125	20	20	46.6	50 to 75	6.0	23					
GNDF R/L2020K-623-070	20	20	125	20	20	46.6	70 to 110	6.0	23					
GNDF R/L2020K-623-100	20	20	125	20	20	46.6	100 to 200	6.0	23	6	BX0520	LH040	\$161.33	20
GNDF R/L2020K-623-180	20	20	125	20	20	46.6	180 to 300	6.0	23					
GNDF R/L2020K-623-280	20	20	125	20	20	46.6	280 to 1000	6.0	23					
GNDF R/L2525M-312-035	25	25	150	25	25	35.6	35 to 45	3.0	12					
GNDF R/L2525M-312-040	25	25	150	25	25	35.6	40 to 55	3.0	12					
GNDF R/L2525M-318-050	25	25	150	25	25	41.6	50 to 70	3.0	18					
GNDF R/L2525M-318-065	25	25	150	25	25	41.6	65 to 100	3.0	18	3	BX0520	LH040	\$164.00	20
GNDF R/L2525M-318-090	25	25	150	25	25	41.6	90 to 150	3.0	18					
GNDF R/L2525M-318-140	25	25	150	25	25	41.6	140 to 200	3.0	18					
GNDF R/L2525M-318-180	25	25	150	25	25	41.6	180 to 300	3.0	18					
GNDF R/L2525M-418-040	25	25	150	25	25	41.6	40 to 55	4.0	18					
GNDF R/L2525M-423-050	25	25	150	25	25	46.6	50 to 70	4.0	23					
GNDF R/L2525M-423-065	25	25	150	25	25	46.6	65 to 90	4.0	23					
GNDF R/L2525M-423-085	25	25	150	25	25	46.6	85 to 130	4.0	23	4	BX0520	LH040	\$166.67	20
GNDF R/L2525M-423-125	25	25	150	25	25	46.6	125 to 200	4.0	23					
GNDF R/L2525M-423-180	25	25	150	25	25	46.6	180 to 300	4.0	23					
GNDF R/L2525M-423-280	25	25	150	25	25	46.6	280 to 1000	4.0	23					
GNDF R/L2525M-523-050	25	25	150	25	25	46.6	50 to 70	5.0	23					
GNDF R/L2525M-523-065	25	25	150	25	25	46.6	65 to 90	5.0	23					
GNDF R/L2525M-523-085	25	25	150	25	25	46.6	85 to 130	5.0	23	5	BX0520	LH040	\$169.33	20
GNDF R/L2525M-523-125	25	25	150	25	25	46.6	125 to 200	5.0	23					
GNDF R/L2525M-523-180	25	25	150	25	25	46.6	180 to 300	5.0	23					
GNDF R/L2525M-523-280	25	25	150	25	25	46.6	280 to 1000	5.0	23					
GNDF R/L2525M-623-050	25	25	150	25	25	46.6	50 to 75	6.0	23					
GNDF R/L2525M-623-070	25	25	150	25	25	46.6	70 to 110	6.0	23					
GNDF R/L2525M-623-100	25	25	150	25	25	46.6	100 to 200	6.0	23	6	BX0520	LH040	\$172.00	20
GNDF R/L2525M-623-180	25	25	150	25	25	46.6	180 to 300	6.0	23					
GNDF R/L2525M-623-280	25	25	150	25	25	46.6	280 to 1000	6.0	23					

Select holders and inserts with the same grooving widths (w).

Please see page 8 for applicable inserts

External Multi-purpose Shallow Grooves Type (Grooving, Turning, and Copying)

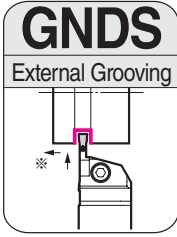
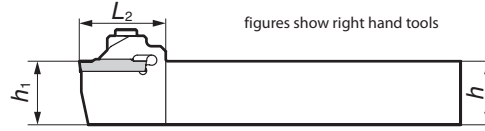
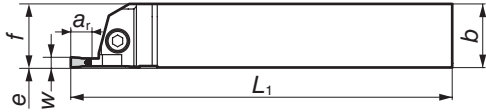

METRIC Catalog Number	Dimensions (mm)						Groove Width w(mm)	Max. Groove Depth ar (mm)	Insert Seat Size	Cap Screw	Wrench	Kit Price	Buy Inserts Get Holder FREE
	h	b	L ₁	f	h ₁	L ₂							
GNDS R/L2020K-206	20	20	125	20	20	30.0	2.0	6	2	BX0520	LH040	\$150.67	20
GNDS R/L2020K-306	20	20	125	20	20	30.0	3.0	6	3			\$153.33	
GNDS R/L2020K-410	20	20	125	20	20	34.0	4.0	10	4			\$156.00	
GNDS R/L2020K-510	20	20	125	20	20	34.0	5.0	10	5			\$158.67	
GNDS R/L2020K-610	20	20	125	20	20	34.0	6.0	10	6			\$161.33	
GNDS R/L2525M-206	25	25	150	25	25	30.0	2.0	6	2			\$161.33	
GNDS R/L2525M-306	25	25	150	25	25	30.0	3.0	6	3			\$164.00	
GNDS R/L2525M-410	25	25	150	25	25	34.0	4.0	10	4			\$166.67	
GNDS R/L2525M-510	25	25	150	25	25	34.0	5.0	10	5			\$169.33	
GNDS R/L2525M-610	25	25	150	25	25	34.0	6.0	10	6			\$172.00	

Select holders and inserts with the same grooving widths (w).

Internal Grooving

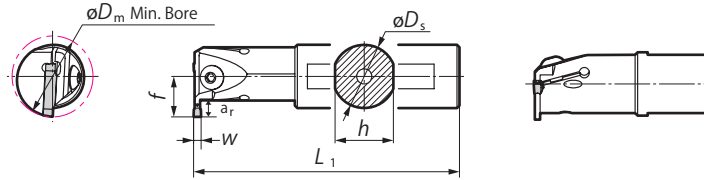

■ Inch Boring Bar

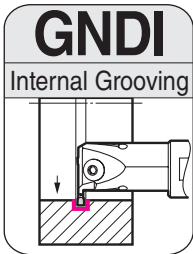

INCH Catalog Number	Dimensions (in)					Max Groove Depth ar (inch)	Insert Seat Size W	Kit Price	Buy Inserts Get Bar FREE
	Shank Diameter	h	Overall L ₁	f	Min. Bore D _m				
GNDIR/L162T-25	1.000	0.906	8.000	0.630	1.250	0.250	2	\$216.00	30
GNDIR/L163T-25	1.000	0.906	8.000	0.630	1.250	0.250	3	\$218.67	
GNDIR/L164T-25	1.000	0.906	8.000	0.630	1.250	0.250	4	\$221.33	
GNDIR/L165T-25	1.000	0.906	8.000	0.630	1.250	0.250	5	\$224.00	
GNDIR/L166T-25	1.000	0.906	8.000	0.630	1.250	0.250	6	\$226.67	
GNDIR/L202T-40	1.250	1.181	10.000	1.024	1.575	0.400	2	\$318.67	
GNDIR/L203T-40	1.250	1.181	10.000	1.024	1.575	0.400	3	\$321.33	
GNDIR/L204T-40	1.250	1.181	10.000	1.024	1.575	0.400	4	\$324.00	
GNDIR/L205T-40	1.250	1.181	10.000	1.024	1.575	0.400	5	\$326.67	
GNDIR/L206T-40	1.250	1.181	10.000	1.024	1.575	0.400	6	\$329.33	
GNDIR/L243T-43	1.500	1.421	12.000	1.145	2.000"	0.430	3	\$377.33	
GNDIR/L244T-43	1.500	1.421	12.000	1.145	2.000"	0.430	4	\$380.00	
GNDIR/L245T-43	1.500	1.421	12.000	1.145	2.000"	0.430	5	\$382.67	
GNDIR/L246T-43	1.500	1.421	12.000	1.145	2.000"	0.430	6	\$385.33	

■ Metric Boring Bar

METRIC Catalog Number	Dimensions (mm)					Max. Groove Depth ar (mm)	Insert Seat Size W	Kit Price	Buy Inserts Get Bar FREE
	Shank Diameter	h	Overall L ₁	f	Min. Bore D _m				
GNDIR/L2532-T206	25	23	200	16	32	6	2	\$216.00	30
GNDIR/L2532-T306	25	23	200	16	32	6	3	\$218.67	
GNDIR/L2532-T406	25	23	200	16	32	6	4	\$221.33	
GNDIR/L2532-T506	25	23	200	16	32	6	5	\$224.00	
GNDIR/L3240-T210	32	30	250	26	40	10	2	\$318.67	
GNDIR/L3240-T310	32	30	250	26	40	10	3	\$321.33	
GNDIR/L3240-T410	32	30	250	26	40	10	4	\$324.00	
GNDIR/L3240-T510	32	30	250	26	40	10	5	\$326.67	
GNDIR/L4050-T311	40	38	300	31	50	11	3	\$377.33	
GNDIR/L4050-T411	40	38	300	31	50	11	4	\$380.00	
GNDIR/L4050-T511	40	38	300	31	50	11	5	\$382.67	
GNDIR/L4050-T611	40	38	300	31	50	11	6	\$385.33	

Please see page 8 for applicable inserts

External Multi-Purpose Type (Grooving, Turning, Profiling)

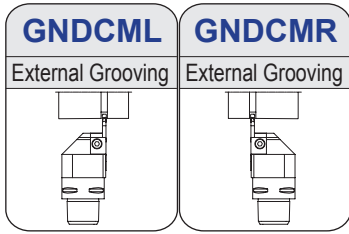

Use for multi-purpose or profiling insert for turning (wide grooves).

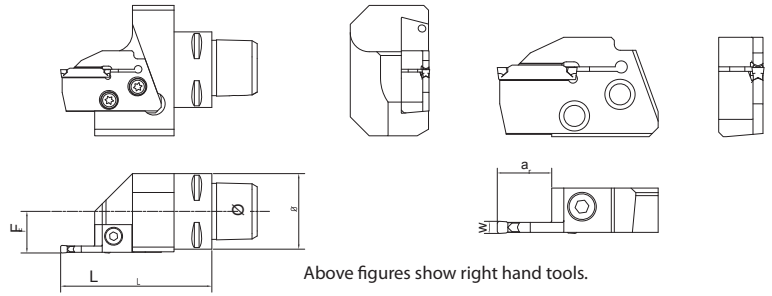

Above figures show right hand tools.

Right handed Cassette goes with right handed holder
Left handed Cassette goes with left handed holder

Cassette (R/L)	Catalog Number	Stock	Grooving Width w (mm)	Grooving Depth a ₁ (mm)	Inserts	Cap Screw	Tightening Torque (N-m)	Wrench	PSC40 Kit Price	PSC50 Kit Price	
	GNDCMR/L212	★	2	12	GCM □2002-□□	BX0515	5.0	LH040	\$385.33	\$421.33	
	GNDCMR/L312	★	3	12	GCM □30□□-□□				\$388.00	\$424.00	
	GNDCMR/L418	★	4	18	GCM □40□□-□□				6.0	\$390.67	\$426.67
	GNDCMR/L518	★	5	18	GCM □50□□-□□					\$393.33	\$429.33
	GNDCMR/L618	★	6	18	GCM □60□□-□□					\$396.00	\$432.00
Holder (R/L)	Catalog Number	Stock	∅	F	L	Cap Screw	Tightening Torque (N-m)	Wrench	Kit Price Includes Holder, Cassette and 5 Inserts		
PSC40GM00R/L	★	40 mm	22 mm	80 mm	BFTX0619N	7.5	TRD25	See PSC40 Kit Price above			
PSC50GM00R/L	★	50mm	27 mm	80 mm				See PSC50 Kit Price above			

★: Worldwide Warehouse Item

External Multi-Purpose Type (Grooving, Turning, Profiling)

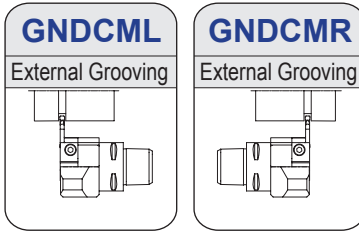

Use for multi-purpose or profiling insert for turning (wide grooves).

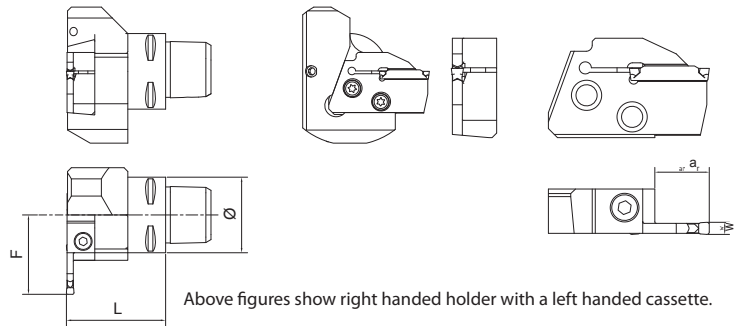

Above figures show right handed holder with a left handed cassette.

Right handed Cassette goes with left handed holder
Left handed Cassette goes with right handed holder

Cassette (R/L)	Catalog Number	Stock	Grooving Width w (mm)	Grooving Depth a ₁ (mm)	Inserts	Cap Screw	Tightening Torque (N-m)	Wrench	PSC40 Kit Price	PSC50 Kit Price	
	GND CML/R212	★	2	12	GCM □2002-□□	BX0515	5.0	LH040	\$385.33	\$421.33	
	GND CML/R312	★	3	12	GCM □30□□-□□				\$388.00	\$424.00	
	GND CML/R418	★	4	18	GCM □40□□-□□				6.0	\$390.67	\$426.67
	GND CML/R518	★	5	18	GCM □50□□-□□					\$393.33	\$429.33
	GND CML/R618	★	6	18	GCM □60□□-□□					\$396.00	\$432.00
Holder (R/L)	Catalog Number	Stock	∅	F	L	Cap Screw	Tightening Torque (N-m)	Wrench	Kit Price Includes Holder, Cassette and 5 Inserts		
PSC40GM90R/L	★	40 mm	22 mm	80 mm	BFTX0619N	7.5	TRD25	See PSC40 Kit Price above			
PSC50GM90R/L	★	50 mm	27 mm	80 mm				See PSC50 Kit Price above			

★: Worldwide Warehouse Item

Offer valid through July 31, 2017

WEX 90° Shoulder Mill

End/Shell Mills



Milling Kit includes:
Milling Cutter and
10 Inserts

* Kit Prices italicized have 20 inserts

Features & Benefits

- The unique shape and strength of the cutting edge has been optimized resulting in reduced cutting forces
- Available in 4 different insert geometries
- A wide range of machining applications due to the new “Super ZX” and “Super FF”, and diamond-like carbon coatings
- Cutter body and insert strength provide for high feed rate capabilities
- Efficient chip removal due to air/coolant hole design

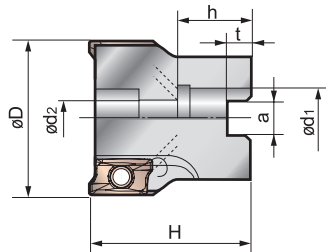
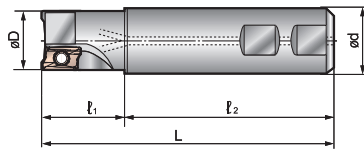

WEX Endmill - Inch

Catalog No.	Dimensions (Inches)					Ramp Angle	# of Teeth	WEX Kit Price*	Buy Inserts Get Cutter FREE
	D	d	L	l ₁	l ₂				
WEX20500EW	0.500	0.750	3.325	1.309	2.031	5°	1	\$148.00	40
WEX20625EW	0.625	0.625	3.218	1.312	1.906	4°	2	\$151.00	60
WEX20625EMW	0.625	0.625	3.591	1.685	1.906	4°	2	\$156.00	60
WEXC20750EW	0.750	0.750	3.561	1.530	2.031	4°	2	\$157.00	60
WEXC20750ELC	0.750	0.750	8.000	2.000	6.000	4°	2	\$170.00	60
WEX20750EW	0.750	0.750	3.561	1.530	2.031	4°	3	\$169.00	70
WEX20750EMW	0.750	0.750	4.091	2.060	2.031	4°	3	\$181.00	70
WEX20750ELW	0.750	0.750	5.091	3.060	2.031	4°	3	\$189.00	70
WEX20750ELC	0.750	0.750	10.000	3.080	6.920	4°	3	\$192.00	80
WEXC21000EW	1.000	1.000	3.812	1.531	2.281	2°	3	\$180.00	70
WEXC21000EMW	1.000	1.000	4.841	2.560	2.281	2°	3	\$185.00	80
WEX21000EW	1.000	1.000	3.812	1.530	2.281	2°	4	\$185.00	80
WEX21000ELC	1.000	1.000	10.000	3.157	6.843	2°	4	\$198.00	90
WEX21250EW	1.250	1.250	4.531	2.250	2.281	1°30'	5	\$195.00	100
WEX31000EW	1.000	1.000	3.811	1.530	2.281	5°	2	\$160.00	60
WEX31000EMW	1.000	1.000	4.841	2.560	2.281	5°	2	\$173.00	60
WEX31000ELW	1.000	1.000	6.341	4.060	2.281	5°	2	\$177.00	60
WEX31000ELC	1.000	1.000	10.000	3.137	6.863	5°	2	\$180.00	70
WEX31250EW	1.250	1.250	4.531	2.250	2.281	3°	3	\$169.00	70
WEX31250EMW	1.250	1.250	6.381	4.100	2.281	3°	3	\$181.00	70
WEX31250ELC	1.250	1.250	10.000	3.149	6.851	3°	3	\$185.00	80
WEXC31500EMW	1.500	1.500	6.421	4.140	2.281	2°	3	\$200.00	80
WEX31500EW	1.500	1.250	4.531	2.250	2.281	2°	4	\$214.00	80
WEX31500ELC	1.500	1.500	10.000	3.149	7.000	2°	4	\$245.00	90
WEX32000EW	2.000	1.250	4.531	2.250	2.281	2°	5	\$247.00	100

WEX Shell Mill - Inch

Catalog No.	Dimensions (Inches)							Ramp Angle	# of Teeth	WEX Kit Price*	Buy Inserts Get Cutter FREE
	D	d ₁	d ₂	a	t	H	h				
WEX21500R	1.500	0.750	0.406	0.312	0.187	1.562	0.750	2°	6	\$302.00	120
WEX22000R	2.000	0.750	0.406	0.312	0.187	1.562	0.750	1°	7	\$325.00	130
WEX22500R	2.500	1.000	0.531	0.375	0.218	1.562	0.750	0°30'	8	\$351.00	140
WEX32000R	2.000	0.750	0.406	0.312	0.187	1.562	0.750	1°	5	\$243.00	100
WEX32500R	2.500	1.000	0.531	0.375	0.218	1.562	0.750	0°30'	6	\$276.00	120
WEXC33000R	3.000	1.000	0.531	0.375	0.218	1.750	0.750	0°30'	5	\$255.00	120
WEX33000R	3.000	1.000	0.531	0.375	0.218	1.750	0.750	0°30'	7	\$301.00	140
WEXC34000R	4.000	1.250	0.656	0.500	0.281	2.000	0.750	N/A	6	\$288.00	130
WEX34000R-1.50	4.000	1.500	0.781	0.626	0.380	2.461	1.535	N/A	6	\$288.00	130
WEX34000R	4.000	1.250	0.656	0.500	0.281	2.000	0.750	N/A	8	\$350.00	150
WEX34000R-1.50	4.000	1.500	0.781	0.626	0.380	2.461	1.535	N/A	8	\$350.00	150
WEXC36000R	6.000	1.500	1.500	0.625	0.380	2.500	1.060	N/A	8	\$750.00	240
WEX38000R	8.000	2.500	2.500	1.000	0.560	2.500	1.250	N/A	12	\$1,165.00	360

Kit Prices italicized have 20 inserts

*Suggested Retail Price in USD

Offer valid through July 31, 2017

WEX 90° Shoulder Mill

Inserts

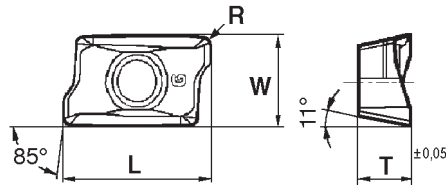
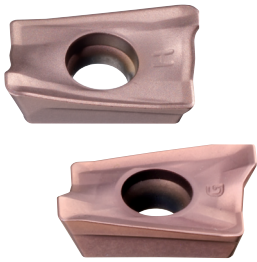

Max. Depth of Cut
 AXMT12: 10mm (.394")
 AXMT17: 14mm (.551")

**Milling Kit includes:
 Milling Cutter and
 10 Inserts**

* Kit Prices italicized have 20 inserts

**Now available
 in ACM grades for
 Stainless Steel and
 Exotic Materials!**

WEX2000 Inserts														
Insert	P			K		M	S	N		Dimensions (Inches)				
	ACP100	ACP200	ACP300	ACK200	ACK300	ACM200	ACM300	DL1000	H1	L	W	T	R	Facet Width
AXMT123504PEERG	●	●	●	●	●					.472	.260	.138	.016	.061
AXMT123504PEERH	●	●	●	●	●					.472	.260	.138	.016	.061
AXMT123508PEERG	●	●	●	●	●					.472	.260	.138	.031	.061
AXMT123508PEERH	●	●	●	●	●					.472	.260	.138	.031	.061
AXMT123512PEERG	●	●	●	●	●					.472	.260	.138	.047	.061
AXMT123512PEERH	●	●	●	●	●					.472	.260	.138	.047	.061
AXMT123504PEERE						●	●			.472	.260	.138	.016	.061
AXMT123508PEERE						●	●			.472	.260	.138	.031	.061
AXMT123508PEEREH						●	●			.472	.260	.138	.031	.061
AXMT123512PEERE						●	●			.472	.260	.138	.047	.061
AXMT123516PEERE						●	●			.472	.260	.138	.063	.061
AXMT123524PEERE						●	●			.472	.260	.138	.094	.061
AXMT123532PEERE						●	●			.472	.260	.138	.126	.061
AXET123502PEFRS								●	●	.472	.260	.138	.008	.061
AXET123504PEFRS								●	●	.472	.260	.138	.016	.061
AXET123508PEFRS								●	●	.472	.260	.138	.031	.061
WEX3000 Inserts														
AXMT170504PEERG	●	●	●	●	●					.689	.402	.219	.016	.118
AXMT170508PEERG	●	●	●	●	●					.689	.402	.219	.031	.118
AXMT170508PEERH	●	●	●	●	●					.689	.402	.219	.031	.118
AXMT170508PEERL	●	●	●	●	●					.689	.402	.219	.031	.118
AXMT170512PEERG	●	●	●	●	●					.689	.402	.219	.047	.118
AXMT170512PEERH	●	●	●	●	●					.689	.402	.219	.047	.118
AXMT170516PEERG	●	●	●	●	●					.689	.402	.219	.063	.118
AXMT170520PEERG	●	●	●	●	●					.689	.402	.219	.079	.118
AXMT170530PEERG	●	●	●	●	●					.689	.402	.219	.118	.118
AXMT170532PEERG	●									.689	.402	.219	.126	.118
AXMT170504PEERE						●	●			.689	.402	.219	.016	.118
AXMT170508PEERE						●	●			.689	.402	.219	.031	.118
AXMT170508PEEREH						●	●			.689	.402	.219	.031	.118
AXMT170512PEERE						●	●			.689	.402	.219	.047	.118
AXMT170516PEERE						●	●			.689	.402	.219	.063	.118
AXMT170520PEERE						●	●			.689	.402	.219	.079	.118
AXMT170524PEERE						●	●			.689	.402	.219	.094	.118
AXMT170530PEERE						●	●			.689	.402	.219	.118	.118
AXMT170531PEERE						●	●			.689	.402	.219	.122	.118
AXMT170548PEERE	●			●	●	●	●			.689	.402	.219	.189	.118
AXMT170563PEERE						●	●			.689	.402	.219	.248	.118
AXET170502PEFRS								●	●	.689	.402	.219	.008	.118
AXET170504PEFRS								●	●	.689	.402	.219	.016	.118
AXET170508PEFRS								●	●	.689	.402	.219	.031	.118

● USA stocked item

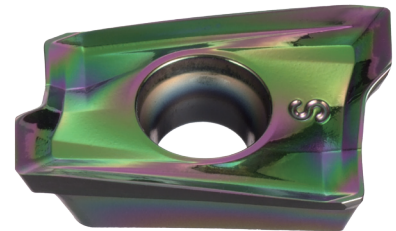
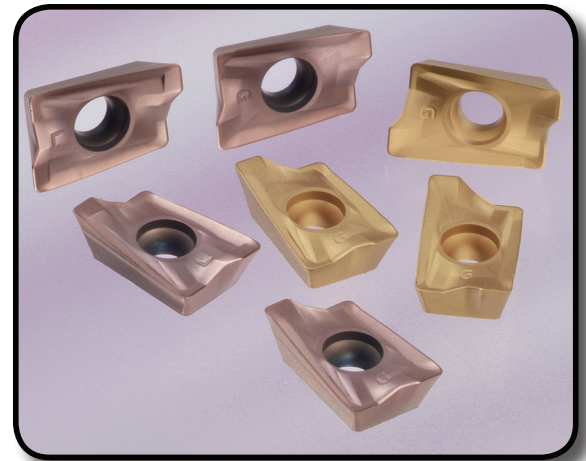

DL1000



H1

Offer valid through July 31, 2017

WFX 90° Shoulder Mill

4-cornered inserts

Offer valid through July 31, 2017



Features & Benefits

WFX is a screw-down type cutter capable of using four-cornered inserts. Ideal cutting edge design offers exceptional squareness. The insert shape is optimized for shoulder milling. When combined with a high-precision body it leaves a superior machined surface finish.

- **Max. depth of cut (ap):** 0.394" (10.0mm)
- With oil hole: ø5.0" or less

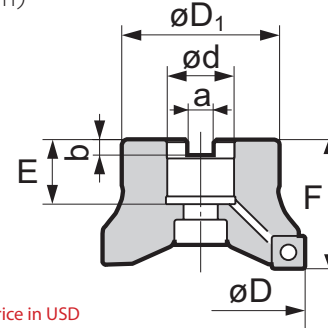

Milling Kit includes:
Milling Cutter and
10 Inserts

* Kit Prices italicized have 20 inserts



*Suggested Retail Price in USD

WFX - Coarse Pitch - Inch									WFX Kit Price*	Buy Inserts Get Cutter FREE
Catalog No.	Dimensions (Inches)							# of Teeth		
	D	d ₁	F	d	a	b	E			
WFX42000R	2.000	1.500	1.750	0.750	0.312	0.187	0.750	3	\$247.00	80
WFX42500R	2.500	1.750	1.750	1.000	0.375	0.218	0.750	4	\$279.00	90
WFX43000R	3.000	2.250	1.750	1.000	0.375	0.218	0.750	4	\$318.00	90
WFX44000R	4.000	2.870	2.000	1.250	0.500	0.280	0.750	5	\$376.00	100
WFX44000R-1.50	4.000	4.000	2.500	1.500	0.625	0.380	1.000	5	\$376.00	100
WFX45000R	5.000	3.750	2.500	1.500	0.625	0.380	1.000	6	\$486.00	120
WFX46000R	6.000	4.380	2.500	1.500	0.625	0.380	1.060	8	\$653.00	170
WFX48000R	8.000	5.120	2.500	2.500	1.000	0.560	1.595	10	\$868.00	210
WFXF - Fine Pitch - Inch									WFX Kit Price*	Buy Inserts Get Cutter FREE
Catalog No.	Dimensions (Inches)							# of Teeth		
	D	d ₁	F	d	a	b	E			
WFXF42000R	2.000	1.500	1.750	0.750	0.312	0.187	1.020	4	\$273.00	90
WFXF42500R	2.500	1.750	1.750	1.000	0.375	0.218	1.020	5	\$318.00	100
WFXF43000R	3.000	2.250	1.750	1.000	0.375	0.218	1.020	6	\$363.00	110
WFXF44000R	4.000	2.870	2.000	1.250	0.500	0.280	1.060	7	\$415.00	120
WFXF44000R-1.50	4.000	4.000	2.500	1.500	0.625	0.380	1.000	7	\$415.00	120
WFXF45000R	5.000	3.750	2.500	1.500	0.625	0.380	1.060	8	\$544.00	140
WFXF46000R	6.000	4.380	2.500	1.500	0.625	0.380	1.060	12	<i>\$752.00</i>	180
WFXF48000R	8.000	5.120	2.500	2.500	1.000	0.560	1.595	16	<i>\$977.00</i>	240
WFXX - Extra Fine Pitch - Inch									WFXX Kit Price*	Buy Inserts Get Cutter FREE
Catalog No.	Dimensions (Inches)							# of Teeth		
	D	d ₁	F	d	a	b	E			
WFXX42000R	2.000	1.500	1.750	0.750	0.312	0.187	1.020	5	\$292.00	100
WFXX42500R	2.500	1.750	1.750	1.000	0.375	0.218	1.020	6	\$337.00	110
WFXX43000R	3.000	2.250	1.750	1.000	0.375	0.218	1.020	8	\$408.00	130
WFXX44000R	4.000	2.870	2.000	1.250	0.500	0.280	1.060	10	\$571.00	150
WFXX44000R-1.50	4.000	4.000	2.500	1.500	0.625	0.380	1.000	10	\$571.00	150
WFXX45000R	5.000	3.750	2.500	1.500	0.625	0.380	1.060	12	<i>\$726.00</i>	170

Slot Milling

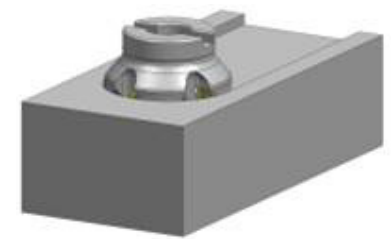

Side - Face Milling



Face Milling

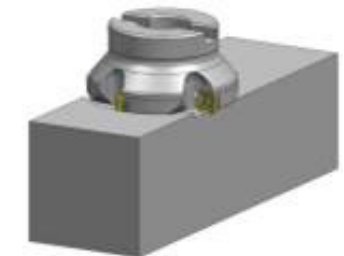

Shoulder Milling

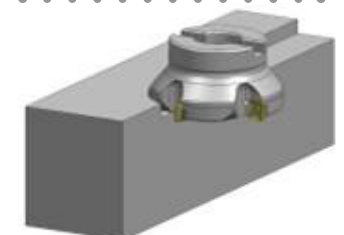

Catalog No. ● USA stocked item	P		K	M	S	N				
	ACP100	ACP200	ACP300	T4500A	ACK200	ACK300	ACM200	ACM300	DL1000	H1
SOMT 120408PDER-L	●	●	●	●	●	●	●	●	●	●
SOMT 120404PDER-G	●	●	●	●	●	●	●	●	●	●
SOMT 120408PDER-G	●	●	●	●	●	●	●	●	●	●
SOMT 120412PDER-G	●	●	●	★	●	●	●	●	●	●
SOMT 120416PDER-G	●	●	●	●	●	●	●	●	●	●
SOMT 120408PDER-H	●	●	●	●	●	●	●	●	●	●
SOET 120408PDR-S	●	●	●	●	●	●	●	●	●	●
XOEW 120408PDTR-AW	●	●	●	●	●	●	●	●	●	●

SOMT / SOET

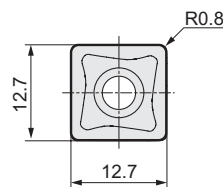

XOEW

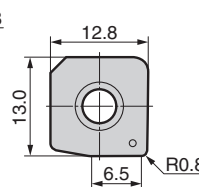

DFC 90° Milling Cutter

Double-sided, 6 edge inserts

Offer valid through July 31, 2017

Features & Benefits



- High toughness insert design enables stable cutting and high efficiency machining with high feed rate
- Optimized machining accuracy by separating the insert contact areas and the cutting edges
- Large lineup for DFC available from 1" through 8"
- Standard, fine pitch and extra-fine pitch styles
- **Max Depth of Cut: 6mm (0.240")**

**Economical
Six Edged
Insert!**

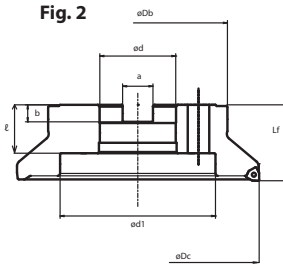
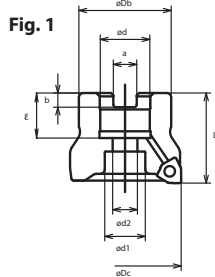

**Milling Kit includes:
Milling Cutter and
10 Inserts**

* Kit Prices italicized have 20 inserts

Cat. No.	Dimensions (in.)									No. of Teeth	Weight (lbs)	Fig.	DFC Kit Price*	Buy Inserts Get Cutter FREE
	øDc	øDb	Lf	ød	a	b	ℓ	ød1	ød2					
DFC22000R	2.000	1.500	1.750	0.750	0.312	0.190	0.750	0.609	0.406	4	0.75	1	\$310.00	70
DFC22500R	2.500	1.750	1.750	1.000	0.375	0.220	0.750	0.797	0.531	5	1.08	1	\$350.00	80
DFC23000R	3.000	2.250	1.750	1.000	0.375	0.220	0.750	0.797	0.531	6	1.81	1	\$395.00	90
DFC24000R	4.000	2.870	2.000	1.250	0.500	0.280	0.750	1.000	0.656	6	3.84	1	\$440.00	100
DFC24000R-1.50	4.000	3.150	2.500	1.500	0.625	0.380	1.000	2.000	1.181	6	4.76	1	\$440.00	100
DFC25000R	5.000	3.750	2.500	1.500	0.625	0.380	1.000	2.000	1.181	7	7.87	1	\$555.00	110
DFC26000R	6.000	4.380	2.500	1.500	0.625	0.380	1.000	2.000	1.181	8	11.64	1	\$735.00	120
DFC28000R	8.000	5.906	2.500	2.500	1.000	0.560	1.594	5.118	-	10	15.00	2	\$835.00	180
DFCM - Fine Pitch - Inch														
DFCM22000R	2.000	1.500	1.750	0.750	0.312	0.190	0.750	0.609	0.406	5	0.75	1	\$335.00	80
DFCM22500R	2.500	1.750	1.750	1.000	0.375	0.220	0.750	0.797	0.531	6	1.05	1	\$390.00	90
DFCM23000R	3.000	2.250	1.750	1.000	0.375	0.220	0.750	0.797	0.531	8	1.79	1	\$435.00	110
DFCM24000R	4.000	2.870	2.000	1.250	0.500	0.280	0.750	1.000	0.656	10	3.79	1	\$495.00	120
DFCM24000R-1.50	4.000	3.150	2.500	1.500	0.625	0.380	1.000	2.000	1.181	10	4.67	1	\$495.00	120
DFCM25000R	5.000	3.750	2.500	1.500	0.625	0.380	1.000	2.000	1.181	12	7.78	1	\$710.00	130
DFCM26000R	6.000	4.380	2.500	1.500	0.625	0.380	1.000	2.000	1.181	14	11.55	1	\$835.00	160
DFCM28000R	8.000	5.906	2.500	2.500	1.000	0.560	1.594	5.118	-	15	14.79	2	\$1,030.00	200
DFCF - Extra Fine Pitch - Inch														
DFCF22000R	2.000	1.500	1.750	0.750	0.312	0.190	0.750	0.609	0.406	6	0.71	1	\$350.00	90
DFCF22500R	2.500	1.750	1.750	1.000	0.375	0.220	0.750	0.797	0.531	7	1.03	1	\$395.00	110
DFCF23000R	3.000	2.250	1.750	1.000	0.375	0.220	0.750	0.797	0.531	9	1.76	1	\$455.00	120
DFCF24000R	4.000	2.870	2.000	1.250	0.500	0.280	0.750	1.000	0.656	11	3.64	1	\$595.00	130
DFCF24000R-1.50	4.000	3.150	2.500	1.500	0.625	0.380	1.000	2.000	1.181	11	4.54	1	\$595.00	130
DFCF25000R	5.000	3.750	2.500	1.500	0.625	0.380	1.000	2.000	1.181	14	7.54	1	\$730.00	160
DFCF26000R	6.000	4.380	2.500	1.500	0.625	0.380	1.000	2.000	1.181	16	11.29	1	\$860.00	180
DFCF28000R	8.000	5.906	2.500	2.500	1.000	0.560	1.594	5.118	-	20	14.59	2	\$1,170.00	220

*Suggested Retail Price in USD Kit Prices italicized have 20 inserts

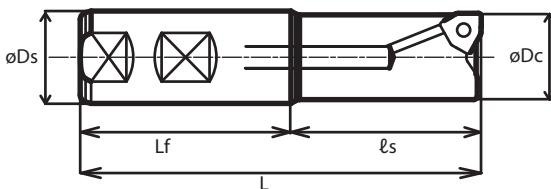

XNMU Inserts

Max. Depth of Cut: 6mm (.236")

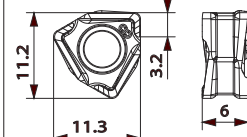
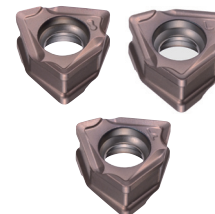

• USA stocked item
Catalog Number

Cat. No.	Dimensions (in.)					No. of Teeth	Weight (lbs)	DFC Kit Price*	Buy Inserts Get Cutter FREE	XNMU Catalog Number	Material				Radius
	øDc	øDs	Lf	ℓs	L						P	K	M	S	
DFC21000EW	1.000	1.000	2.060	2.281	4.341	2	0.77	\$220.00	30	XNMU060604PNER-L	●	●	●	●	.016
DFC21250EW	1.250	1.250	2.060	2.281	4.341	3	1.26	\$235.00	40	XNMU060608PNER-L	●	●	●	●	.031
DFC21500EW	1.500	1.250	2.060	2.281	4.341	3	1.52	\$240.00	50	XNMU060604PNER-G	●	●	●	●	.016
DFC22000EW	2.000	1.250	2.060	2.281	4.341	4	1.72	\$265.00	60	XNMU060608PNER-G	●	●	●	●	.031
DFC22500EW	2.500	1.250	2.060	2.281	4.341	5	2.12	\$300.00	60	XNMU060612PNER-G	●	●	●	●	.047
DFCM21500EW	1.500	1.250	2.060	2.281	4.341	4	1.50	\$264.00	60	XNMU060616PNER-G	●	●	●	●	.063
DFCM22000EW	2.000	1.250	2.060	2.281	4.341	5	1.70	\$295.00	70	XNMU060608PNER-H	●	●	●	●	.031
DFCM22500EW	2.500	1.250	2.060	2.281	4.341	7	2.07	\$355.00	70	XNMU060612PNER-H	●	●	●	●	.047
										XNMU060616PNER-H	●	●	●	●	.063

WGX 45° Face Mill

4-cornered inserts

Features & Benefits

Stable Machining

Special chipbreaker designed for WGX Type ensures low cutting resistance

High Quality

Improved run-out precision and unique wiper edge shape ensure excellent surface finish quality. Optimized chamfer shape reduces burrs and edge chipping

Max Depth of Cut: 6mm (0.240")



Milling Kit includes:
Milling Cutter and
10 Inserts

* Kit Prices italicized have 20 inserts

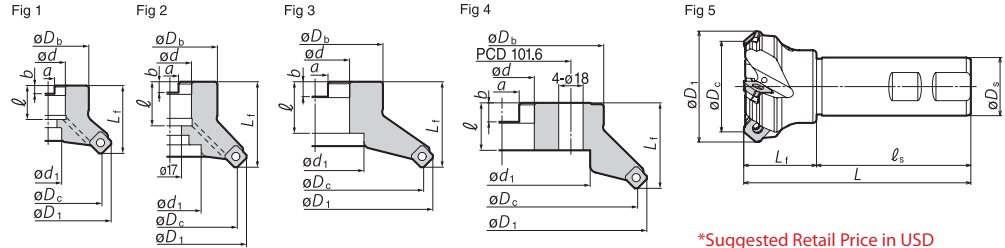

*Suggested Retail Price in USD

Kit Prices italicized have 20 inserts

Cutter diameters 6.000" and above do not have coolant holes

WGX - Standard Pitch - Inch												WGX Kit Price*	Buy Inserts Get Cutter FREE	
Catalog No.	ϕD_c	ϕD_1	ϕD_b	L_f	ϕd	ϕd_1	a	b	ℓ	Teeth	Weight (lbs)			Fig.
WGX42000R	2.000	2.461	1.500	1.750	0.750	0.609	0.312	0.190	0.750	3	0.9	1	\$264.00	90
WGX42500R	2.500	3.008	1.750	1.750	1.000	0.797	0.375	0.220	0.750	4	1.3	1	\$292.00	100
WGX43000R	3.000	3.504	2.250	1.750	1.000	0.787	0.375	0.220	0.750	4	2.2	1	\$315.00	110
WGX44000R	4.000	4.500	2.870	2.000	1.250	1.000	0.500	0.280	0.750	5	3.5	2	\$387.00	140
WGX44000R-1.50	4.000	4.500	3.750	2.500	1.500	2.000	0.625	0.380	1.000	5	4.5	3	\$387.00	140
WGX45000R	5.000	5.496	3.750	2.500	1.500	2.000	0.625	0.380	1.000	6	7.2	1	\$469.00	170
WGX46000R	6.000	6.496	4.380	2.500	1.500	2.000	0.625	0.380	1.060	7	9.5	3	\$530.00	190
WGX48000R	8.000	8.496	5.906	2.500	2.500	5.118	1.000	0.560	1.594	8	15.6	4	\$659.00	240
WGX410000R	10.000	10.492	7.480	2.756	2.500	6.299	1.000	0.531	1.575	10	23.5	4	\$936.00	340
WGX - Fine Pitch - Inch												WGX Kit Price*	Buy Inserts Get Cutter FREE	
Catalog No.	ϕD_c	ϕD_1	ϕD_b	L_f	ϕd	ϕd_1	a	b	ℓ	Teeth	Weight (lbs)			Fig.
WGXM42000R	2.000	2.461	1.500	1.750	0.750	0.609	0.312	0.190	0.750	4	0.9	1	\$288.00	90
WGXM42500R	2.500	3.008	1.750	1.750	1.000	0.797	0.375	0.220	0.750	5	1.9	1	\$316.00	110
WGXM43000R	3.000	3.504	2.250	1.750	1.000	0.787	0.375	0.220	0.750	6	3.1	1	\$351.00	120
WGXM44000R	4.000	4.500	2.870	2.000	1.250	1.000	0.500	0.280	0.750	7	4.8	2	\$423.00	150
WGXM44000R-1.50	4.000	4.500	3.750	2.500	1.500	2.000	0.625	0.380	1.000	7	5.5	3	\$423.00	150
WGXM45000R	5.000	5.496	3.750	2.500	1.500	2.000	0.625	0.380	1.000	8	7.2	1	\$504.00	180
WGXM46000R	6.000	6.496	4.380	2.500	1.500	2.000	0.625	0.380	1.060	10	9.5	3	\$646.00	220
WGXM48000R	8.000	8.496	5.906	2.500	2.500	5.118	1.000	0.560	1.594	12	15.6	4	\$788.00	280
WGX - Extra Fine Pitch - Inch												WGX Kit Price*	Buy Inserts Get Cutter FREE	
Catalog No.	ϕD_c	ϕD_1	ϕD_b	L_f	ϕd	ϕd_1	a	b	ℓ	Teeth	Weight (lbs)			Fig.
WGXF42000R	2.000	2.461	1.500	1.750	0.750	0.609	0.312	0.190	0.750	5	0.9	1	\$323.00	100
WGXF42500R	2.500	3.008	1.750	1.750	1.000	0.797	0.375	0.220	0.750	6	1.5	1	\$355.00	120
WGXF43000R	3.000	3.504	2.250	1.750	1.000	0.787	0.375	0.220	0.750	8	3.1	1	\$398.00	140
WGXF44000R	4.000	4.500	2.870	2.000	1.250	1.000	0.500	0.280	0.750	10	4.7	2	\$517.00	170
WGXF44000R-1.50	4.000	4.500	3.750	2.500	1.500	2.000	0.625	0.380	1.000	10	6.5	3	\$517.00	170
WGXF45000R	5.000	5.496	3.750	2.500	1.500	2.000	0.625	0.380	1.000	12	8.2	1	\$611.00	200
WGXF46000R	6.000	6.496	4.380	2.500	1.500	2.000	0.625	0.380	1.060	16	10.5	3	\$731.00	250
WGXF48000R	8.000	8.496	5.906	2.500	2.500	5.118	1.000	0.560	1.594	20	15.2	4	\$960.00	310

WGX Endmill - Inch										WGX Kit Price*	Buy Inserts Get Cutter FREE
Catalog No.	ϕD_c	ϕD_1	ϕD_s	L_f	ℓ_s	L	Teeth	Fig.			
WGX42000EW	2.000	2.461	1.250	1.591	2.379	3.970	4	5	\$277.00	90	
WGX42500EW	2.500	3.008	1.250	1.591	2.379	3.970	5	5	\$315.00	110	

Inserts • USA stocked item	P					K	M	S	N	Dimensions			
	ACP100	ACP200	ACP300	T4500A	ACK200	ACK300	ACM200	ACM300	DL1000	H1	I.C.	Thickness	Facet Width
	•	•	•	•	•	•	•	•	•	•	•	•	•
SEMT13T3AGSR-L	•	•	•	•	•	•	•	•	•	•	•	•	•
SEMT13T3AGSR-G	•	•	•	•	•	•	•	•	•	•	•	•	•
SEMT13T3AGSR-H	•	•	•	•	•	•	•	•	•	•	•	•	•
SEMT13T3AGSR-FG	•	•	•	•	•	•	•	•	•	•	•	•	•
SEET13T3AGSR-L	•	•	•	•	•	•	•	•	•	•	•	•	•
SEET13T3AGSR-G	•	•	•	•	•	•	•	•	•	•	•	•	•
SEET13T3AGFR-L	•	•	•	•	•	•	•	•	•	•	•	•	•
XEEW13T3AGER-AWR	•	•	•	•	•	•	•	•	•	•	•	•	•

Excellent surface finish!
Eliminate burrs!

Part Exit Comparison

Competitor A



Competitor A leaves burrs

WGX



WGX leaves no burr

Parts	Applicable Cutters	Seat	Seat Screw	Insert Screw	Spanner (For Insert)	Recommended Tightening Torque Inch / Lbs	Spanner (For Seat)
WGX cutters except for model below	WGCS13R	BW0507F	BFTX03512IP	TRDR15IP	25	LH035	
WG13032EW	—	—	BFTX03512IP	TRDR15IP	25	—	

DGC 45° Face Mill

Double-sided inserts (SNMT & ONMT)

Features & Benefits



Superior economy

With the same sharpness of similar one-sided inserts, you get twice the corners. Also, the cutter body holds both the ONMT & SNMT inserts (no shim change), allowing up to 16 corners

Max. Depth of Cut: SNMT: 6mm (.240") ONMT: 3mm (.120")

Sumitomo WGX and DGC Comparison

Needs	Surface Finish	Cutting Force	High Feed Rate	Insert Strength	Chip Evacuation	Cost Per Edge	General Versatility
Recommend	WGX	WGX	DGC	DGC	WGX	DGC	WGX

DGC - Coarse Pitch - Inch

Catalog Number	φDc	φD1	φDb	Lf	φD	φd1	a	b	ℓ	Teeth	Fig.	DGC Kit Price*	Buy Inserts Get Cutter FREE
DGC42000R	2.000	2.567	1.500	1.750	0.750	0.609	0.312	0.190	0.750	3	1	\$334.00	70
DGC42500R	2.500	3.067	1.750	1.750	1.000	0.797	0.375	0.220	0.750	4	1	\$396.00	80
DGC43000R	3.000	3.567	2.250	1.750	1.000	0.787	0.375	0.220	0.750	4	1	\$414.00	80
DGC44000R	4.000	4.567	2.870	2.000	1.250	1.000	0.500	0.280	0.750	5	1	\$538.00	100
DGC44000R-1.50	4.000	4.000	3.750	2.500	1.500	2.000	0.625	0.380	1.000	5	4	\$538.00	100
DGC45000R	5.000	5.567	3.750	2.500	1.500	2.000	0.625	0.380	1.000	6	1	\$584.00	110
DGC46000R	6.000	6.567	4.380	2.500	1.500	2.000	0.625	0.380	1.060	7	2	\$779.00	150
DGC48000R	8.000	8.567	5.906	2.500	2.500	5.118	1.000	0.560	1.594	8	2	\$957.00	180
DGC410000R	10.000	10.567	7.480	2.756	2.500	6.299	1.000	0.531	1.575	10	2	\$1,190.00	240

DGC - Fine Pitch - Inch

DGCM42000R	2.000	2.567	1.500	1.750	0.750	0.609	0.312	0.190	0.750	4	1	\$363.00	80
DGCM42500R	2.500	3.067	1.750	1.750	1.000	0.797	0.375	0.220	0.750	5	1	\$429.00	100
DGCM43000R	3.000	3.567	2.250	1.750	1.000	0.787	0.375	0.220	0.750	6	1	\$477.00	110
DGCM44000R	4.000	4.567	2.870	2.000	1.250	1.000	0.500	0.280	0.750	7	1	\$609.00	130
DGCM44000R-1.50	4.000	4.000	3.750	2.500	1.500	2.000	0.625	0.380	1.000	7	4	\$609.00	130
DGCM45000R	5.000	5.567	3.750	2.500	1.500	2.000	0.625	0.380	1.000	8	1	\$646.00	140
DGCM46000R	6.000	6.567	4.380	2.500	1.500	2.000	0.625	0.380	1.060	10	2	\$956.00	180
DGCM48000R	8.000	8.567	5.906	2.500	2.500	5.118	1.000	0.560	1.594	12	2	\$1,154.00	220

DGC - Extra Fine Pitch - Inch

DGCF42000R	2.000	2.567	1.500	1.750	0.750	0.609	0.312	0.190	0.750	5	1	\$390.00	90
DGCF42500R	2.500	3.067	1.750	1.750	1.000	0.797	0.375	0.220	0.750	6	1	\$459.00	110
DGCF43000R	3.000	3.567	2.250	1.750	1.000	0.787	0.375	0.220	0.750	8	1	\$512.00	130
DGCF44000R	4.000	4.567	2.870	2.000	1.250	1.000	0.500	0.280	0.750	10	1	\$792.00	160
DGCF44000R-1.50	4.000	4.000	3.750	2.500	1.500	2.000	0.625	0.380	1.000	10	4	\$792.00	160
DGCF45000R	5.000	5.567	3.750	2.500	1.500	2.000	0.625	0.380	1.000	12	1	\$820.00	170
DGCF46000R	6.000	6.567	4.380	2.500	1.500	2.000	0.625	0.380	1.060	14	2	\$1,031.00	210
DGCF48000R	8.000	8.567	5.906	2.500	2.500	5.118	1.000	0.560	1.594	16	2	\$1,215.00	250

DGC Endmill - Inch

Catalog Number	φDc	φD1	φDb	Lf	ℓs	L	Teeth	Fig.	DGC Kit Price*	Buy Inserts Get Cutter FREE
DGC42000EW	2.000	2.567	1.250	1.591	2.379	3.970	4	3	\$351.00	80
DGC42500EW	2.000	2.567	1.250	1.591	2.379	3.970	5	3	\$424.00	100

Inserts

Catalog Number ● USA stocked item	P		K	M	S	H				
	ACP100	ACP200	ACP300	T4500A	ACK200	ACK300	ACM200	ACM300	H1	DL1000
SNMT13T6ANER-L	●	●	●	●	●	●	●	●		
SNMT13T6ANER-G	●	●	●	●	●	●	●	●		
SNMT13T6ANER-H	●	●	●	●	●	●	●	●		
SNMT13T6ANER-FL	●	●	●	●	●	●	●	●		
SNMT13T6ANER-FG	●	●	●	●	●	●	●	●		
SNET13T6ANER-L							●	●		
SNET13T6ANER-G							●	●		
SNET13T6ANER-FL							●	●		
SNET13T6ANER-FG							●	●		
SNET13T6ANFR-S									●	●
ONMT05T6ANER-L	●	●	●	●	●	●	●	●		
ONMT05T6ANER-G	●	●	●	●	●	●	●	●		
ONET05T6ANER-L							●	●		
ONET05T6ANER-G							●	●		
XNEU13T6ANER-W	●		●	●	●	●				

Max. Depth of Cut *Suggested Retail Price in USD
SNMT: 6mm (.240") Kit Prices italicized have 20 inserts
ONMT: 3mm (.120")

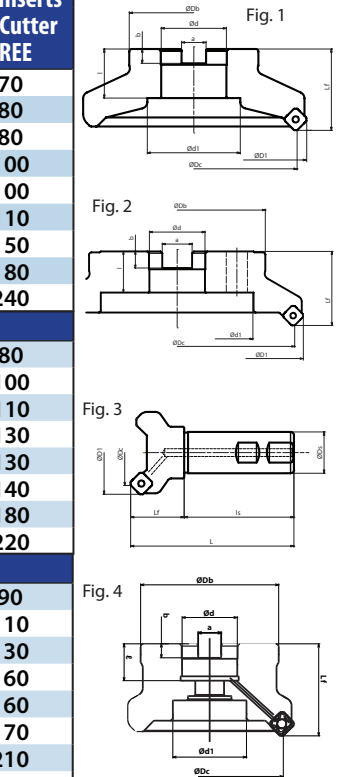
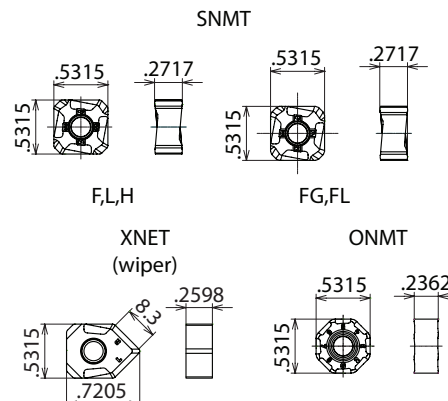

Milling Kit includes:
Milling Cutter and
10 Inserts

* Kit Prices italicized have 20 inserts

**Up to
8 corners:
SNMT inserts!**

**Up to
16 corners:
ONMT inserts!**

Offer valid through July 31, 2017

MSX High Feed Mill End/Shell Mills



Features & Benefits

- High feed rates- up to .055 IPT significantly reduces cycle time
- Higher clamping rigidity due to double clamping system
- Capable of ramping and helical applications
- Available in Weldon (EW) and Cylindrical (ELC) type shanks
- **Max. Depth of Cut:** WDMT06: .039" (1.0mm) WDMT08: .059" (1.5mm)
WDMT12: .079" (2.0mm) WDMT14: .098" (2.5mm)

*Suggested Retail Price in USD

MSX Endmill - Inch

Catalog Number	øD _C	øD _S	L	L _f	ℓ _s	No. of Teeth	Insert Type	MSX Kit Price	Buy Inserts Get Cutter FREE
MSX20750EW	0.750	0.750	5.125	2.000	2.031	3	WDMT06	\$200.00	70
MSX20750ELC	0.750	0.750	8.000	2.000	6.000	3		\$180.00	70
MSX31000EW	1.000	1.000	4.781	2.500	2.281	2	WDMT08	\$240.00	60
MSX31000ELC	1.000	1.000	10.000	2.500	7.500	2		\$215.00	60
MSXF31000EW	1.000	1.000	4.781	2.500	2.281	3	WDMT08	\$230.00	80
MSXF31250EW	1.250	1.250	4.781	2.500	2.281	3		\$235.00	80
MSXF31500EW	1.500	1.500	4.781	2.500	2.281	4	WDMT12	\$300.00	90
MSX41250EW	1.250	1.250	4.781	2.500	2.281	2		\$260.00	60
MSX41250ELC	1.250	1.250	10.000	2.500	7.500	2	WDMT12	\$230.00	60
MSX41500EW	1.500	1.250	4.781	2.500	2.281	2		\$270.00	60
MSX41500ELC	1.500	1.500	10.000	2.500	7.500	2	WDMT12	\$235.00	60
MSXF41500EW	1.500	1.500	4.781	2.500	2.281	3		\$265.00	80

MSX Shell Mills - Inch

Catalog Number	Dimensions (in)									No. of Teeth	Insert	MSX Kit Price	Buy Inserts Get Cutter FREE
	øD _C	øD ₁	L _f	ød	a	b	ℓ ₁	ød ₁	ød ₂				
MSX31500R	1.500	1.339	1.530	0.750	0.312	0.190	0.750	0.609	0.406	4	WDMT08	\$290.00	100
MSX32000R	2.000	1.850	2.000	0.750	0.312	0.190	0.750	0.609	0.406	5		\$330.00	120
MSX42000R	2.000	1.850	2.000	0.750	0.312	0.190	0.750	0.609	0.406	4	WDMT12	\$334.00	90
MSXM42000R	2.000	1.850	2.000	0.750	0.312	0.190	0.750	0.609	0.406	5		\$345.00	100
MSX42500R	2.500	2.362	2.000	1.000	0.375	0.220	0.750	0.797	0.530	5	WDMT12	\$379.00	110
MSX43000R	3.000	2.756	2.000	1.000	0.375	0.220	0.750	0.797	0.530	6		\$424.00	120
MSX44000R-1.25	4.000	3.740	2.500	1.250	0.500	0.280	0.750	1.000	0.656	7	WDMT14	\$475.00	140
MSX44000R-1.50	4.000	3.740	2.500	1.500	0.625	0.380	1.000	2.000	0.781	7		\$475.00	140
MSX52000R	2.000	1.850	2.000	0.750	0.312	0.190	0.750	0.609	0.406	4	WDMT14	\$346.00	100
MSX52500R	2.500	2.362	2.000	1.000	0.375	0.220	0.750	0.797	0.531	5		\$390.00	110
MSX53000R	3.000	2.756	2.000	1.000	0.375	0.220	0.750	0.797	0.531	5	WDMT14	\$447.00	120
MSX54000R-1.25	4.000	3.740	2.500	1.250	0.500	0.280	0.750	1.000	0.656	6		\$505.00	130
MSX54000R-1.50	4.000	3.740	2.500	1.500	0.625	0.380	1.000	2.000	0.781	6	WDMT14	\$505.00	140
MSX55000R	5.000	3.937	2.500	1.500	0.625	0.380	1.000	2.000	0.781	7		\$610.00	140
MSX56000R	6.000	3.937	2.500	1.500	0.625	0.380	1.000	2.000	0.781	8	WDMT14	\$690.00	160

**Milling Kit includes:
Milling Cutter and
10 Inserts**

* Kit Prices italicized have 20 inserts

**Up to
0.055 IPT feed
rates!**

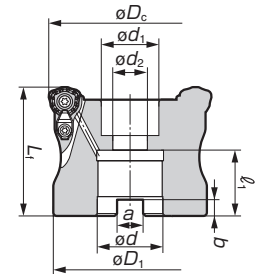
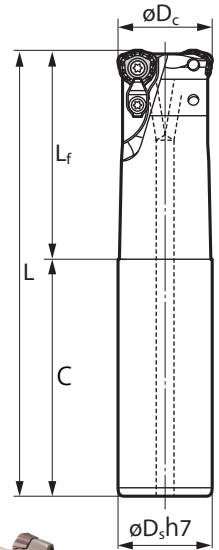

Type	Inserts ● USA stocked item	P					K					M					S					Insert Dimensions (in)	Max Depth of Cut (in.)	General Purpose Edge		H : Strong Edge	
		ACP200	ACP300	ACK200	ACK300	ACM200	ACM300	W	R	t	W	R	t	W	R	t	W	R	t	General (First choice)	Interrupted Cutting						
General Purpose	WDMT0603ZDTR	●	●	●	●	●	●	.250	.0591	.1181	.039	Sharper Edge		Emphasis on Fracture Resistance													
	WDMT0804ZDTR	●	●	●	●	●	●	.335	.0787	.1575	.059																
	WDMT1205ZDTR	●	●	●	●	●	●	.472	.0787	.1969	.079																
	WDMT1406ZDTR	●	●	●	●	●	●	.551	.0787	.2362	.098																
Strong Edge	WDMT0603ZDTR-H	●	●	●	●	●	●	.250	.0591	.1181	.039																
	WDMT0804ZDTR-H	●	●	●	●	●	●	.335	.0787	.1575	.059																
	WDMT1205ZDTR-H	●	●	●	●	●	●	.472	.0787	.1969	.079																
	WDMT1406ZDTR-H	●	●	●	●	●	●	.551	.0787	.2362	.098																

Hardware

Screw	Wrench	Clamp	Ring	Clamp Screw	Applicable Cutter
BFTX02505IP	TRDR08IP	-	-	-	MSX20000
BFTX0305IP	TRDR08IP	CCH3.5	CR3	BFTX03510IP08	MSX30000 ≤1.0"
BFTX0306IP	TRDR08IP	CCH3.5	CR3	BFTX03510IP08	MSX30000 >1.0"
BFTX0409IP	TRDR15IP	CCH3.5	CR3	BFTX03510IP15	MSX40000
BFTX0511IP	TRDR20IP	CCH4.5	CR3	BFTX04513IP20	MSX50000

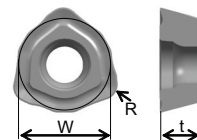

Offer valid through July 31, 2017

RSX Wave Radius Mill

for Stainless Steel & Exotic Material

Features & Benefits

- Wide application range that includes face milling, ramping, slotting, 3-D interpolation, and helical boring
- A highly durable body made of special alloyed steel and protected by a hard surface treatment
- Round pocket design eliminates insert rotation during aggressive machining



Milling Kit includes:
Milling Cutter and
10 Inserts

* Kit Prices italicized have 20 inserts



Kit Prices italicized have 20 inserts *Suggested Retail Price in USD

RSX - Shell Mill - Inch												RSX Kit Price*	Buy Inserts Get Cutter FREE
Catalog No.	φD	φd	F	d ₁	d ₂	d ₃	E	a	Insert Type	# of Inserts	Fig.		
RSX32000R	2.000	1.500	1.750	0.750	0.406	0.609	1.020	0.312	RDET10	4	2	\$300.00	60
RSX42000R	2.000	1.500	1.750	0.750	0.406	0.609	1.020	0.312	RDET12	4		\$310.00	60
RSX42500R	2.500	1.750	1.750	1.000	0.531	0.797	1.020	0.375		5		\$360.00	70
RSX43000R	3.000	2.250	1.750	1.000	0.531	0.797	1.020	0.375	6	\$415.00		80	
RSX44000R-1.25	4.000	2.870	2.000	1.250	0.656	1.000	1.020	0.500	7	\$480.00		90	
RSX44000R-1.50	4.000	2.870	2.500	1.500	0.781	2.000	1.535	0.625	7	\$480.00		90	
RSX45000R	5.000	3.750	2.500	1.500	0.781	2.000	1.312	0.625	8	\$585.00		100	
RSX46000R	6.000	4.380	2.500	1.500	0.781	2.000	1.312	0.625	9	\$685.00		110	
RSX52500R	2.500	1.750	1.750	1.000	0.531	0.797	1.020	0.375	4	\$360.00		60	
RSX53000R	3.000	2.250	1.750	1.000	0.531	0.797	1.020	0.375	5	\$415.00		80	
RSX54000R-1.25	4.000	2.870	2.000	1.250	0.656	1.000	1.020	0.500	7	\$500.00		90	
RSX54000R-1.50	4.000	2.870	2.500	1.500	0.781	2.000	1.535	0.625	7	\$500.00		90	
RSX55000R	5.000	3.750	2.500	1.500	0.781	2.000	1.312	0.625	8	\$605.00	100		
RSX56000R	6.000	4.380	2.500	1.500	0.781	2.000	1.312	0.625	9	\$705.00	110		
RSXF32000R	2.000	1.500	1.750	0.750	0.406	0.609	1.020	0.312	RDET10	6	2	\$320.00	80
RSXF42000R	2.000	1.500	1.750	0.750	0.406	0.609	1.020	0.312	RDET12	5		\$330.00	70
RSXF42500R	2.500	1.750	1.750	1.000	0.531	0.797	1.020	0.375		6		\$380.00	80
RSXF43000R	3.000	2.250	1.750	1.000	0.531	0.797	1.020	0.375	8	\$465.00		100	
RSXF44000R-1.25	4.000	2.870	2.000	1.250	0.656	1.000	1.020	0.500	9	\$540.00		110	
RSXF44000R-1.50	4.000	2.870	2.500	1.500	0.781	2.000	1.535	0.625	9	\$540.00		110	
RSXF45000R	5.000	3.750	2.500	1.500	0.781	2.000	1.312	0.625	11	\$720.00		130	
RSXF46000R	6.000	4.380	2.500	1.500	0.781	2.000	1.312	0.625	12	\$840.00		160	
RSXF52500R	2.500	1.750	1.750	1.000	0.531	0.797	1.020	0.375	5	\$285.00		70	
RSXF53000R	3.000	2.250	1.750	1.000	0.531	0.797	1.020	0.375	6	\$325.00		90	
RSXF54000R-1.25	4.000	2.870	2.000	1.250	0.656	1.000	1.020	0.500	8	\$400.00		110	
RSXF54000R-1.50	4.000	2.870	2.500	1.500	0.781	2.000	1.535	0.625	8	\$400.00		110	
RSXF55000R	5.000	3.750	1.500	1.500	0.781	2.000	1.312	0.625	9	\$475.00	120		
RSXF56000R	6.000	6.000	4.380	2.500	1.500	0.781	2.000	1.312	10	\$560.00	130		

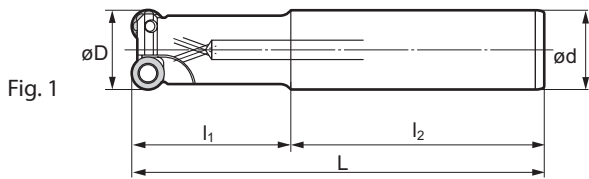
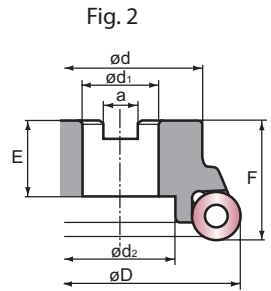

RSX Endmill - Inch											RSX Kit Price*	Buy Inserts Get Cutter FREE
Catalog No.	φD	φd	L	l ₁	l ₂	Insert Type	# of Inserts	Shank Style	Fig.			
RSX31000EW	1.000	1.000	4.340	2.060	2.280	RDET10	2	Weldon	1	\$190.00	30	
RSX31250EW	1.250	1.250	4.340	2.060	2.280	RDET10	3	Weldon		\$245.00	40	
RSX31500EW	1.500	1.250	4.340	2.060	2.280	RDET10	3	Weldon		\$270.00	40	
RSX41250EW	1.250	1.250	4.340	2.060	2.280	RDET12	2	Weldon		\$235.00	40	
RSX41500EW	1.500	1.250	4.340	2.060	2.280	RDET12	3	Weldon		\$280.00	50	
RSXF31000EW	1.000	1.000	4.340	2.060	2.280	RDET10	3	Weldon		\$255.00	40	
RSXF31000ELC	1.000	1.000	10.000	3.750	6.250	RDET10	3	Cylindrical		\$265.00	50	
RSXF31250EW	1.250	1.250	4.340	2.060	2.280	RDET10	4	Weldon		\$305.00	50	
RSXF31250ELC	1.250	1.250	10.000	3.750	6.250	RDET10	4	Cylindrical		\$315.00	60	
RSXF31500EW	1.500	1.250	4.340	2.060	2.280	RDET10	4	Weldon		\$330.00	60	
RSXF31500ELC	1.500	1.250	10.000	3.750	6.250	RDET10	4	Cylindrical		\$340.00	70	
RSXF41250EW	1.250	1.250	4.340	2.060	2.280	RDET12	3	Weldon		\$285.00	50	
RSXF41250ELC	1.250	1.250	10.000	3.750	6.250	RDET12	3	Cylindrical	\$295.00	60		
RSXF41500EW	1.500	1.250	4.340	2.060	2.280	RDET12	4	Weldon	\$340.00	70		
RSXF41500ELC	1.500	1.250	10.000	3.750	6.250	RDET12	4	Cylindrical	\$350.00	80		

Inserts	Dimensions				
	P	K	M	S	I.C.
ACP200	•	•	•	•	•
ACK300	•	•	•	•	•
ACM100	•	•	•	•	•
ACM200	•	•	•	•	•
ACM300	•	•	•	•	•
RDET10T3MOEN-G	•	•	•	•	•
RDET10T3MOEN-H	•	•	•	•	•
RDET1204MOEN-G	•	•	•	•	•
RDET1204MOEN-H	•	•	•	•	•
RDET1606MOEN-G	•	•	•	•	•
RDET1606MOEN-H	•	•	•	•	•

• USA stocked item

Offer valid through
July 31, 2017

CAT40 | CAT50 | SHELL MILL HOLDERS

Offer valid through July 31, 2017

**Special
Promo Price
on Shell Mill
Holders!**

- **CAT40 & CAT50:** through-spindle coolant shell mill holders
- All holders are dynamically balanced to G6.3 tolerance
- Black oxide surface treatment on all non-contact surfaces for corrosion protection

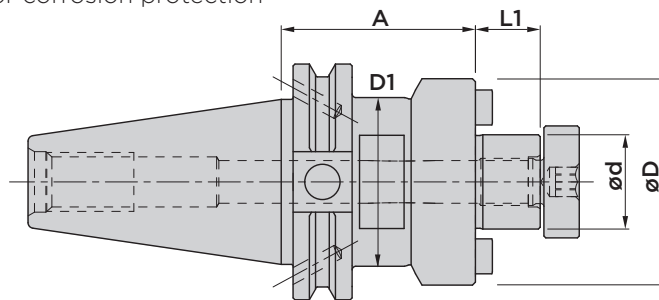
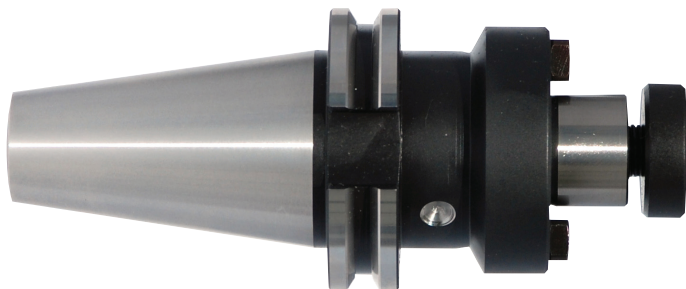

Shell Mill Holders		Balanced to G6.3 @ 8,000 RPM							List Price	25% OFF
Catalog Number	Dimensions									
	Pilot Diameter		Projection Length		øD (mm)	L ₁ (mm)	D ₁ (mm)			
ød (inch)	ød (mm)	A (inch)	A (mm)	Price				Promo		
CAT40										
SSMH-0.750-1.38-CAT40	0.75	19.1	1.38	35.1	44.4	17.5	28.7	\$80.88	\$60.66	
SSMH-1.000-1.75-CAT40	1.00	25.4	1.75	44.5	55.6	17.5	40.1	\$84.93	\$63.70	
SSMH-1.250-2.12-CAT40	1.25	31.8	2.12	53.8	69.9	17.5	50.3	\$93.82	\$70.37	
SSMH-1.500-2.41-CAT40	1.50	38.1	2.41	61.2	85.9	23.9	60.7	\$103.53	\$77.65	
CAT50										
SSMH-0.750-3.50-CAT50	0.75	19.1	3.50	88.9	44.4	17.5	28.7	\$149.63	\$112.22	
SSMH-1.000-4.00-CAT50	1.00	25.4	4.00	101.6	55.6	17.5	40.1	\$155.29	\$116.47	
SSMH-1.250-3.50-CAT50	1.25	31.8	3.50	88.9	69.9	17.5	50.3	\$179.56	\$134.67	
SSMH-1.500-2.40-CAT50	1.50	38.1	2.40	61.0	85.9	23.9	60.7	\$155.29	\$116.47	

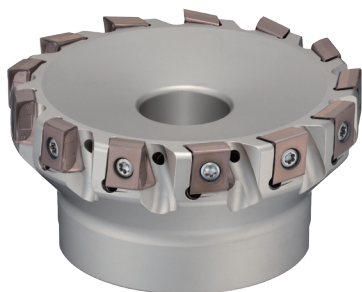

TSX

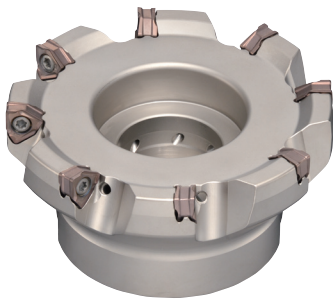

DFC



WGX



MSX

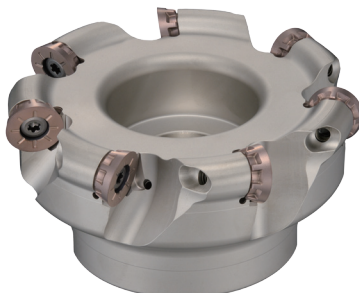

RSX

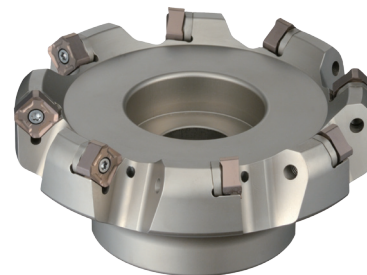

DGC

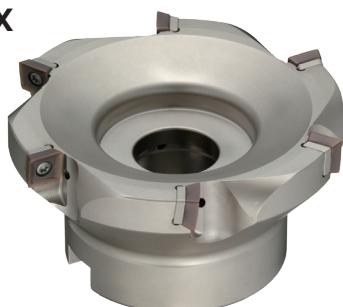

WFX



WEX

WDX

Indexable Coolant Through Drills
Offer valid through July 31, 2017

Kit Price:
Includes 10
FREE Inserts!

Features & Benefits

- Excellent hole accuracy**
New balanced design for stable drilling
- Excellent chip control**
Three chipbreakers for superior chip control
- Wide Application Range**
Insert grades for longer tool life:
ACP300 for steel
ACK300 for cast iron
DL1500 for aluminum
- Economical**
Four-cornered insert design for easy tool management and reduce cost
- Coolant-through Design**
Longer tool life reduces cost per part

Feed Rate Map

- Carbon steel, easy chip controlled steel
- Soft steel, difficult chip controlled steel
- Stainless steel, other adhesional steel
- Aluminum, Non-ferrous Material

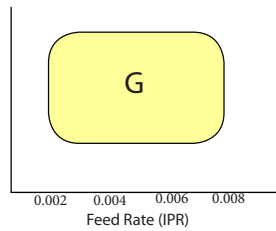
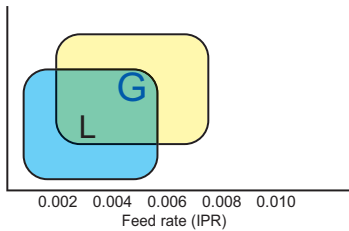
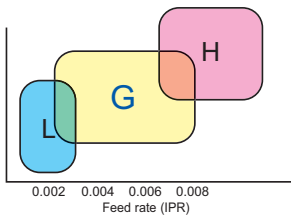
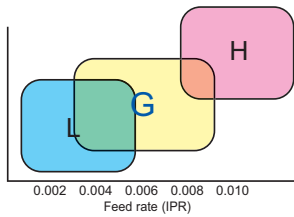

SumiDrill WDX type

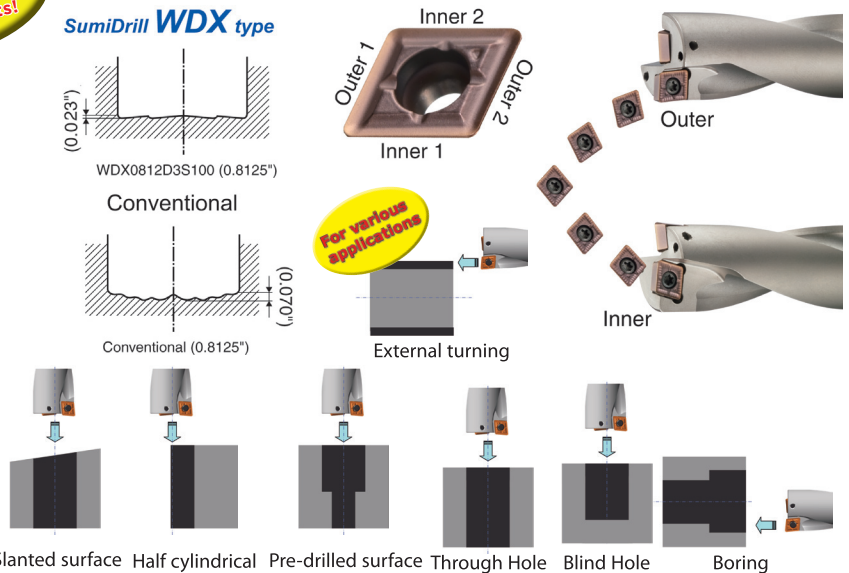

SumiDrill WDX Inserts

Catalog Number	NEW GRADE Stock				Flt	L	T	R	WDX Body
	ACP100	ACP300	ACK300	DL1500					
WDX042004-L	●	●	●	●	3				WDX0562D□
WDX042004-G	●	●	●	●	4	0.1654	0.0788	0.0157	~WDX0594D□
WDX042004-H	●	●	●	●	5				
WDX052504-L	●	●	●	●	3				WDX0625D□
WDX052504-G	●	●	●	●	4	0.1969	0.0984	0.0157	~WDX0687D□
WDX052504-H	●	●	●	●	5				
WDX063006-L	●	●	●	●	3				WDX0750D□
WDX063006-G	●	●	●	●	4	0.2362	0.1181	0.0236	~WDX0875D□
WDX063006-H	●	●	●	●	5				
WDX073506-L	●	●	●	●	3				WDX0937D□
WDX073506-G	●	●	●	●	4	0.2953	0.1378	0.0236	~WDX1125D□
WDX073506-H	●	●	●	●	5				
WDX094008-L	●	●	●	●	3				WDX1187D□
WDX094008-G	●	●	●	●	4	0.3780	0.1575	0.0315	~WDX1437D□
WDX094008-H	●	●	●	●	5				
WDX125012-L	●	●	●	●	3				WDX1500D□
WDX125012-G	●	●	●	●	4	0.4882	0.1969	0.0472	~WDX1750D□
WDX125012-H	●	●	●	●	5				
WDX156012-L	●	●	●	●	3				WDX1813D□
WDX156012-G	●	●	●	●	4	0.5984	0.2362	0.0472	~WDX2125D□
WDX156012-H	●	●	●	●	5				
WDX186012-L	●	●	●	●	3				WDX2250D□
WDX186012-G	●	●	●	●	4	0.7087	0.2362	0.0472	~WDX2625D□
WDX186012-H	●	●	●	●	5				

WDX Recommended Running Conditions

Material	Chipbreaker-Grade	Speed (SFM)	2XD WDX Drill		3XD WDX Drill		4XD & 5XD WDX Drill	
			0.5625" - 1.000"	1.000" - 2.625"	0.5625" - 1.000"	1.000" - 2.625"	0.5625" - 1.000"	1.000" - 2.625"
Steel	G-ACP300	200 - 725	0.002 - 0.010	0.002 - 0.013	0.0015 - 0.008	0.002 - 0.0105	0.002 - 0.007	0.002 - 0.0095
Stainless Steel	L-ACP300	200 - 725	0.0015 - 0.006	0.0015 - 0.008	0.0015 - 0.004	0.0015 - 0.0065	0.0015 - 0.0035	0.0015 - 0.006
Gray Cast Iron	H-ACK300	400 - 650	0.004 - 0.014	0.0045 - 0.017	0.004 - 0.012	0.0045 - 0.0145	0.004 - 0.0105	0.0045 - 0.013
Ductile Iron	H-ACK300	300 - 500	0.004 - 0.014	0.0045 - 0.017	0.004 - 0.012	0.0045 - 0.0145	0.004 - 0.0105	0.0045 - 0.017
Exotic Material	G-ACP300	80 - 250	0.0025 - 0.0075	0.0025 - 0.0095	0.0025 - 0.006	0.0025 - 0.0085	0.0025 - 0.005	0.0025 - 0.0075
Aluminum	G-DL1500	800 - 1500	0.002 - 0.006	0.004 - 0.008	0.002 - 0.006	0.004 - 0.008	0.002 - 0.004	0.003 - 0.007

Material	Prep & Grade	Speed (SFM)	2XD WDX Drill		3XD WDX Drill		4XD & 5XD WDX Drill	
			0.5625" - 1.000"	1.000" - 2.625"	0.5625" - 1.000"	1.000" - 2.625"	0.5625" - 1.000"	1.000" - 2.625"
Steel	L-ACP100	300 - 950	.0015 - .006	.0015 - .008	.0015 - .005	.0015 - .007	.0015 - .005	.0015 - .0065
Steel	G-ACP100	300 - 950	.002 - .010	.002 - .013	.0015 - .008	.0015 - .0105	.002 - .007	0.0025 - .0095
Steel	H-ACP100	300 - 950	.003 - .010	.003 - .013	.003 - .008	.003 - .0105	.003 - .007	.0025 - .0095
Stainless Steel	L-ACP100	350 - 800	.002 - .006	.002 - .008	.0015 - .005	0.0015 - .007	.0015 - .005	.0015 - .007
Stainless Steel	G-ACP100	350 - 800	.0025 - .007	.0025 - .0095	.0025 - .006	.0025 - .0085	.0025 - .005	.0025 - .0075
Stainless Steel	H-ACP100	350 - 800	.003 - .008	.003 - .0105	.0025 - .007	.0025 - .0095	.0025 - .005	.0025 - .0075
Exotic Material	L-ACP100	100 - 350	.002 - .006	.002 - .0085	.002 - .005	.002 - .0075	.0015 - .004	0.0015 - .0065
Exotic Material	G-ACP100	100 - 350	.002 - .0075	.002 - .0095	.002 - .0065	.002 - .0085	.002 - .005	.0025 - .0075
Exotic Material	H-ACP100	100 - 350	.0025 - .0075	.0025 - .0105	.0025 - .0065	.0025 - .0095	.0025 - .005	.0025 - .0075

WDX 4XD INCH - Side Port Coolant Indexable Coolant Through Drills

Sumitomo Electric Carbide, Inc. is now offering WDX-L Indexable Drill with side port coolant. Due to not all spindles being coolant-thru, the WDX-L allows for customers to use coolant through the side port.

Kit Price: Includes Drill & 10 Inserts

Kit Price: Includes 10 FREE Inserts!

Features & Benefits

- Diameters available in 0.5625" to 2.5000"
- WDX-L uses WDXT inserts (same as WDX style)
- Available in 4XD style

● = USA Stocked item

Figure 1

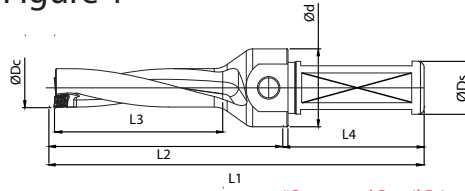
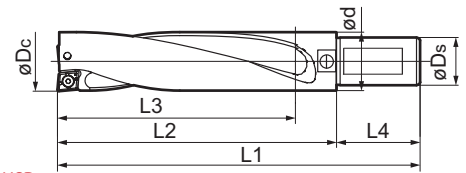

Figure 2



*Suggested Retail Price in USD

SumiDrill WDX Bodies Side Port - 4XD - INCH

Catalog Number	Stock	øDc	L1	L2	L3	ød	øDs	L4	Screw	Wrench	Insert	Pipe Plug	Fig.	SUGGESTED KIT PROMO PRICING*
WDX0562D4S100-L	●	0.5625	5.350	3.350	2.366	1.102	1.000	2.000	BFTX01604N	TRX06	WDXT042004	XP02	1	\$296.50
WDX0594D4S100-L	●	0.5937	5.478	3.478	2.494	1.102	1.000	2.000	BFTX01604N	TRX06	WDXT042004	XP02	1	\$296.50
WDX0625D4S100-L	●	0.6250	6.181	3.681	2.618	1.260	1.000	2.500	BFTX0204N	TRX06	WDXT052504	XP04	1	\$309.45
WDX0656D4S100-L	●	0.6562	6.305	3.805	2.742	1.260	1.000	2.500	BFTX0204N	TRX06	WDXT052504	XP04	1	\$309.45
WDX0687D4S100-L	●	0.6875	6.429	3.929	2.866	1.260	1.000	2.500	BFTX0204N	TRX06	WDXT052504	XP04	1	\$309.45
WDX0750D4S100-L	●	0.7500	6.681	4.181	3.118	1.299	1.000	2.500	BFTY02206	TRD07	WDXT063006	XP04	1	\$326.86
WDX0787D4S100-L	●	0.7870	6.829	4.329	3.266	1.299	1.000	2.500	BFTY02206	TRD07	WDXT063006	XP04	1	\$326.86
WDX0812D4S100-L	●	0.8125	6.931	4.431	3.368	1.299	1.000	2.500	BFTY02206	TRD07	WDXT063006	XP04	1	\$326.86
WDX0875D4S100-L	●	0.8750	7.181	4.681	3.618	1.299	1.000	2.500	BFTY02206	TRD07	WDXT063006	XP04	1	\$326.86
WDX0937D4S125-L	●	0.9375	7.549	5.049	3.868	1.614	1.250	2.500	BFTX02506N	TRD08	WDXT073506	XP04	1	\$344.21
WDX1000D4S125-L	●	1.0000	7.799	5.299	4.118	1.614	1.250	2.500	BFTX02506N	TRD08	WDXT073506	XP04	1	\$344.21
WDX1062D4S125-L	●	1.0625	8.549	5.549	4.368	1.614	1.250	3.000	BFTX02506N	TRD08	WDXT073506	XP04	1	\$355.23
WDX1125D4S125-L	●	1.1250	8.799	5.799	4.618	1.614	1.250	3.000	BFTX02506N	TRD08	WDXT073506	XP04	1	\$355.23
WDX1187D4S125-L	●	1.1875	9.206	6.206	4.907	1.968	1.250	3.000	BFTX03584	TRX15	WDXT094008	XP04	1	\$404.44
WDX1250D4S125-L	●	1.2500	9.456	6.456	5.157	1.968	1.250	3.000	BFTX03584	TRX15	WDXT094008	XP04	1	\$404.44
WDX1312D4S150-L	●	1.3125	9.824	6.824	5.407	2.126	1.500	3.000	BFTX03584	TRX15	WDXT094008	XP04	1	\$404.44
WDX1375D4S150-L	●	1.3750	10.074	7.074	5.657	2.126	1.500	3.000	BFTX03584	TRX15	WDXT094008	XP04	1	\$404.44
WDX1437D4S150-L	●	1.4375	10.324	7.324	5.907	2.126	1.500	3.000	BFTX03584	TRX15	WDXT094008	XP04	1	\$404.44
WDX1500D4S150-L	●	1.5000	10.850	7.850	6.197	1.949	1.500	3.000	BFTX0511N	TRD20	WDXT125012	XP04	1	\$499.57
WDX1562D4S150-L	●	1.5625	11.098	8.098	6.445	1.949	1.500	3.000	BFTX0511N	TRD20	WDXT125012	XP04	1	\$499.57
WDX1625D4S150-L	●	1.6250	11.350	8.350	6.697	1.949	1.500	3.000	BFTX0511N	TRD20	WDXT125012	XP04	1	\$499.57
WDX1687D4S150-L	●	1.6875	11.602	8.602	6.949	1.949	1.500	3.000	BFTX0511N	TRD20	WDXT125012	XP04	2	\$499.57
WDX1750D4S150-L	●	1.7500	11.850	8.850	7.197	1.949	1.500	3.000	BFTX0511N	TRD20	WDXT125012	XP04	2	\$499.57
WDX1812D4S150-L	●	1.8125	12.102	9.102	7.449	1.949	1.500	3.000	BFTX0615N	TRD25	WDXT156012	XP04	2	\$534.67
WDX1875D4S150-L	●	1.8750	12.350	9.350	7.697	1.949	1.500	3.000	BFTX0615N	TRD25	WDXT156012	XP04	2	\$534.67
WDX1937D4S150-L	●	1.9375	12.602	9.602	7.949	1.949	1.500	3.000	BFTX0615N	TRD25	WDXT156012	XP04	2	\$534.67
WDX2000D4S150-L	●	2.0000	12.850	9.850	8.197	1.949	1.500	3.000	BFTX0615N	TRD25	WDXT156012	XP04	2	\$572.66
WDX2125D4S150-L	●	2.1250	13.350	10.350	8.697	1.949	1.500	3.000	BFTX0615N	TRD25	WDXT156012	XP04	2	\$635.40
WDX2250D4S150-L	●	2.2500	14.047	11.047	9.315	2.173	1.500	3.000	BFTX0615N	TRD25	WDXT186012	XP04	2	\$725.91
WDX2375D4S150-L	●	2.3750	14.547	11.547	9.815	2.295	1.500	3.000	BFTX0615N	TRD25	WDXT186012	XP04	2	\$725.91
WDX2500D4S150-L	●	2.5000	15.047	12.047	10.315	2.421	1.500	3.000	BFTX0615N	TRD25	WDXT186012	XP04	2	\$752.25

Sumitomo Electric Carbide Manufacturing, Inc. - SCM WI

5635 S. Westridge Drive
New Berlin, WI 53151
Phone: (800) 950-5202

Indiana Branch

595 S. Emerson Avenue
Suite 100
Greenwood, IN 46143
Phone: (317) 859-1601

Torrance Branch

21241 South Western Avenue
Suite 120
Torrance, CA 90501
Phone: (800) 950-5202
Fax: (310) 782-0211

Sumitomo Electric Carbide, Inc. Headquarters

1001 Business Center Drive
Mount Prospect, IL 60056-2181
P.O. Box 545, Mt. Prospect, IL 60056-0545
Phone: (800) 950-5202
Phone: (847) 635-0044
Fax: (847) 635-7866

Sumitomo Carbide Canada, Inc.

150 Research Lane, Unit #210
Guelph, Ontario N1G 4T2
Canada
Phone: (519) 265-6050
Phone: (844) 211-6050

Detroit Branch

14496 Sheldon Road #230
Plymouth, MI 48170
Phone: (800) 239-5177
Phone: (734) 451-0200
Fax: (734) 451-5338

Huntsville Branch

6700 Odyssey Drive
Suite 211
Huntsville, AL 35806
Phone: (256) 971-1203
Fax: (256) 971-1205

